



NOVA
SUPPLY

PANELES EXTERIORES

(829) 216-9224

Plaza Roaldi, local 308, El Millon, D.N.

✉ info@novasupplyrd.com

🌐 www.novasupplyrd.com

万事达® 丽彩系列
SHINE COLOR SERIES



METAL SANDWICH
PANEL SYSTEM
金属面夹芯板系统



(829) 216-9224

Plaza Roaldi, local 308, El Millon, D.N.

✉ info@novasupplyrd.com

🌐 www.novasupplyrd.com

WHY DO YOU CHOOSE METAL

SANDWICH PANELS OF THE SHINE COLOR SERIES?

为什么选择丽彩系列金属面夹芯板?

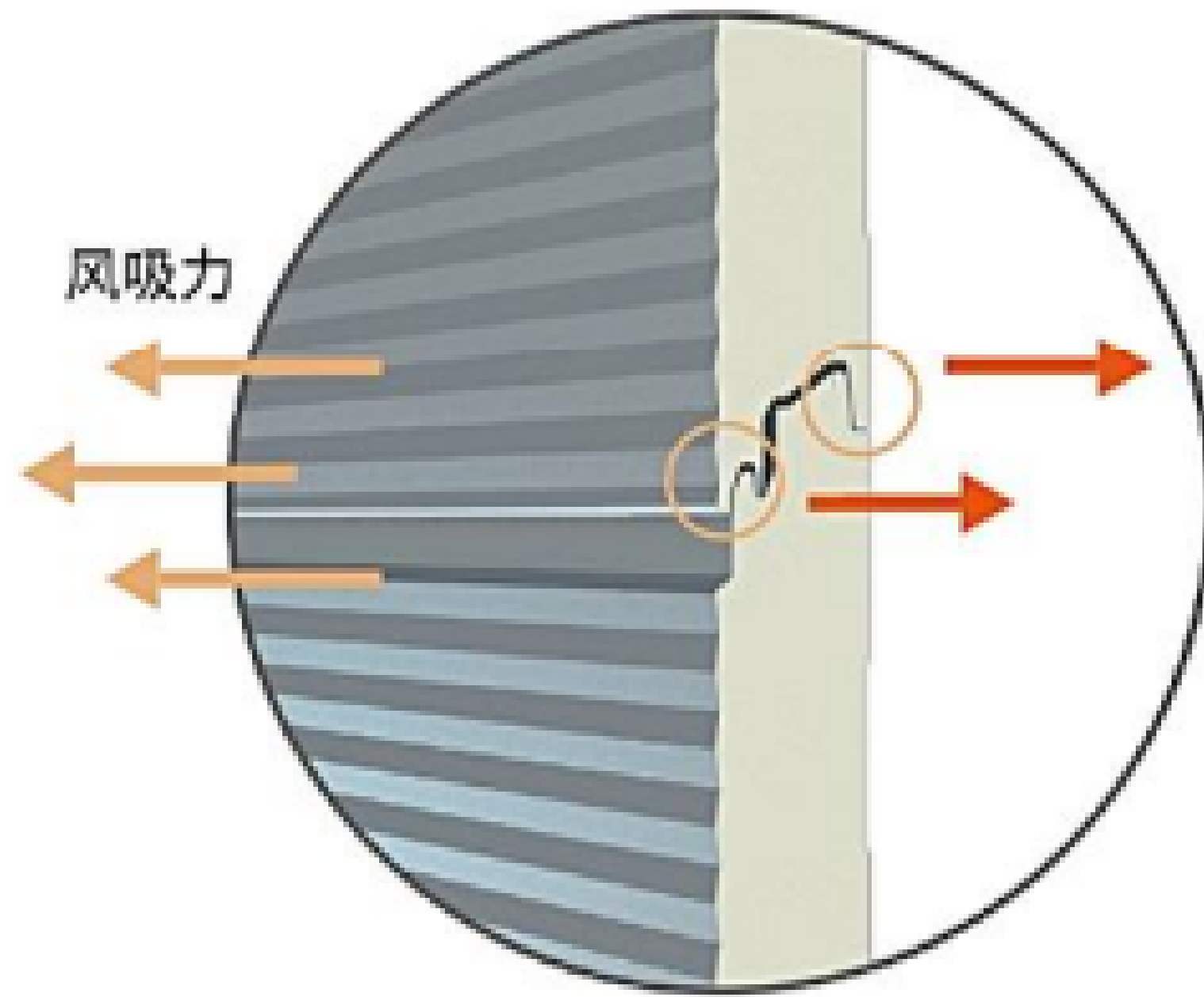

1. 创新的双支撑插接口, 墙面抗负风压能力更强, 更稳固!

Innovative double-support plug interface design ensures that walls have stronger wind pressure-resistant capacity and are solidier.

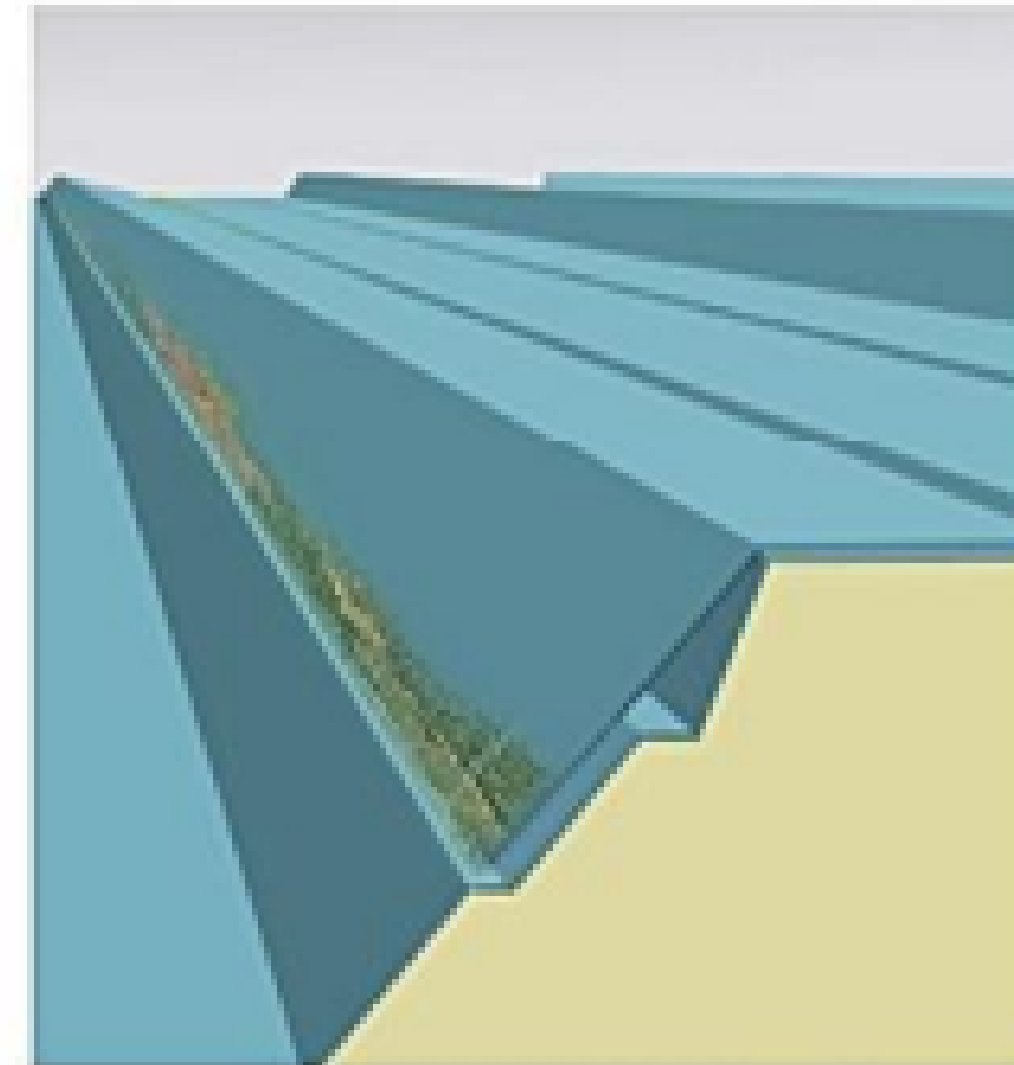

无叠边设计, 雨水浸湿后, 端部因无涂层锈蚀, 影响屋面寿命



叠边设计, 搭接更紧密, 保护无涂层的端部, 提升屋面寿命

2. 独特的端部叠边工艺, 屋面板材使用寿命更长久, 更省钱!

With the unique lapping technique at the edges, the service life of roofing is longer and more economical.



3. 多种功能性、多种板面形式及颜色可选, 内外兼修的产品, 满足建筑更多的个性化需求和更高的舒适性需求。

There are panels of multiple functions, types and colors for your choice. The quality and beautiful products can meet more personalized requirements and higher requirements on comfort in the building industry.



4. 自由定制的一体转角板, 无缝转角, 更美观!

Customized integrated corner panels are seamless and more beautiful.



意大利PUMA夹芯板连续生产线, 六组份在线高压发泡, 28m超长双履带成型。



三十年行业经验积累, 研发更适合中国建筑的节能产品, 已获得国家专利59项。

5. 欧洲技术+中国智慧, 更安心!

European Technology + Chinese Wisdom offer safer products.



6. 产品通过国家权威检测机构检测, 更放心!

The products have passed the tests conducted by national authoritative organizations and are used more confidently.

(829) 216-9224

Plaza Roaldi, local 308, El Millon, D.N.

✉ info@novasupplyrd.com

🌐 www.novasupplyrd.com

COLOR GERM FOUR

TONGUE-AND-GROOVE SANDWICH WALL PANEL

丽彩钻® 幕墙式四企口夹芯板

顶级装配的建筑外衣/防火、节能、装饰一体化高端幕墙板

让工业建筑不像工业建筑的变装神器

Top-notch building cladding/High-end integrated fire-proof, energy-saving and decorative wall panels

Let industrial construction like art



COLORGERM
CASSETTE

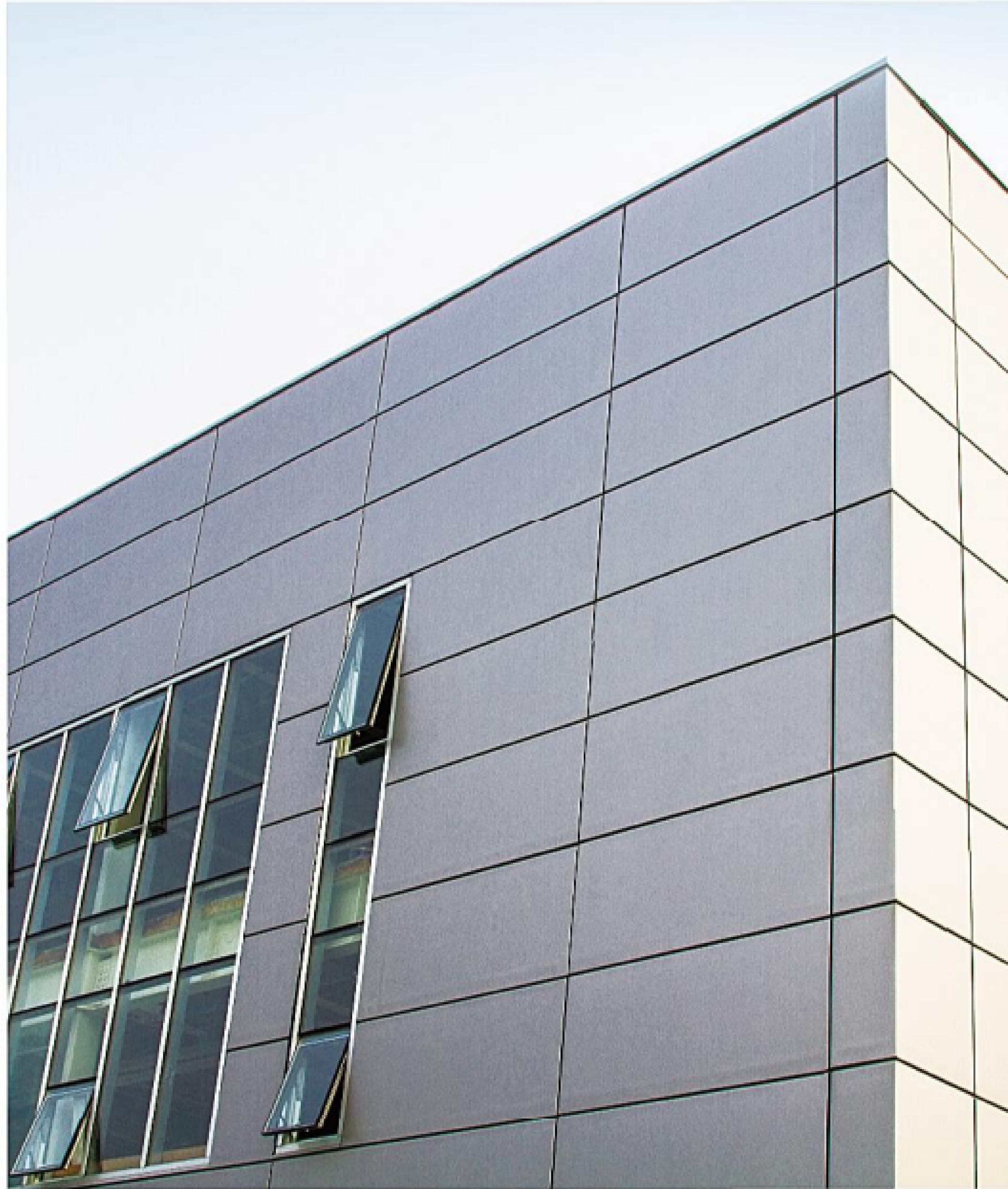

(829) 216-9224

Plaza Roaldi, local 308, El Millon, D.N.

✉ info@novasupplyrd.com

🌐 www.novasupplyrd.com

板型 PANEL TYPE

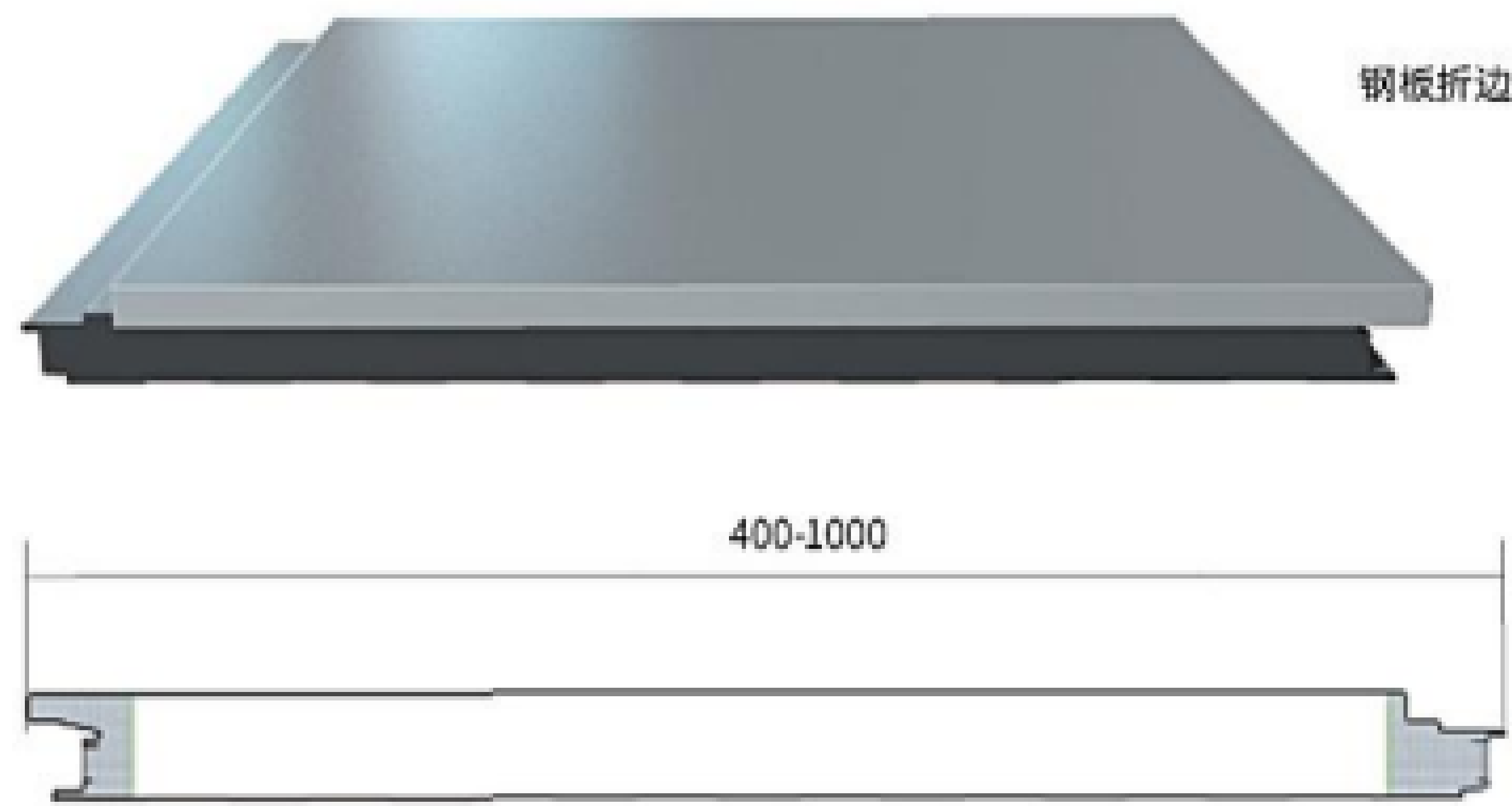

颠覆传统企口设计, 采用盒式四企口处理, 完成后的效果可媲美其他帷幕系统。

Wiskind has changed the traditional tongue-and-groove design, and adopted case-type four tongue-and-groove processing. After completion, the effect can be on a par with other curtain systems.

节点图 NODE DRAWINGS

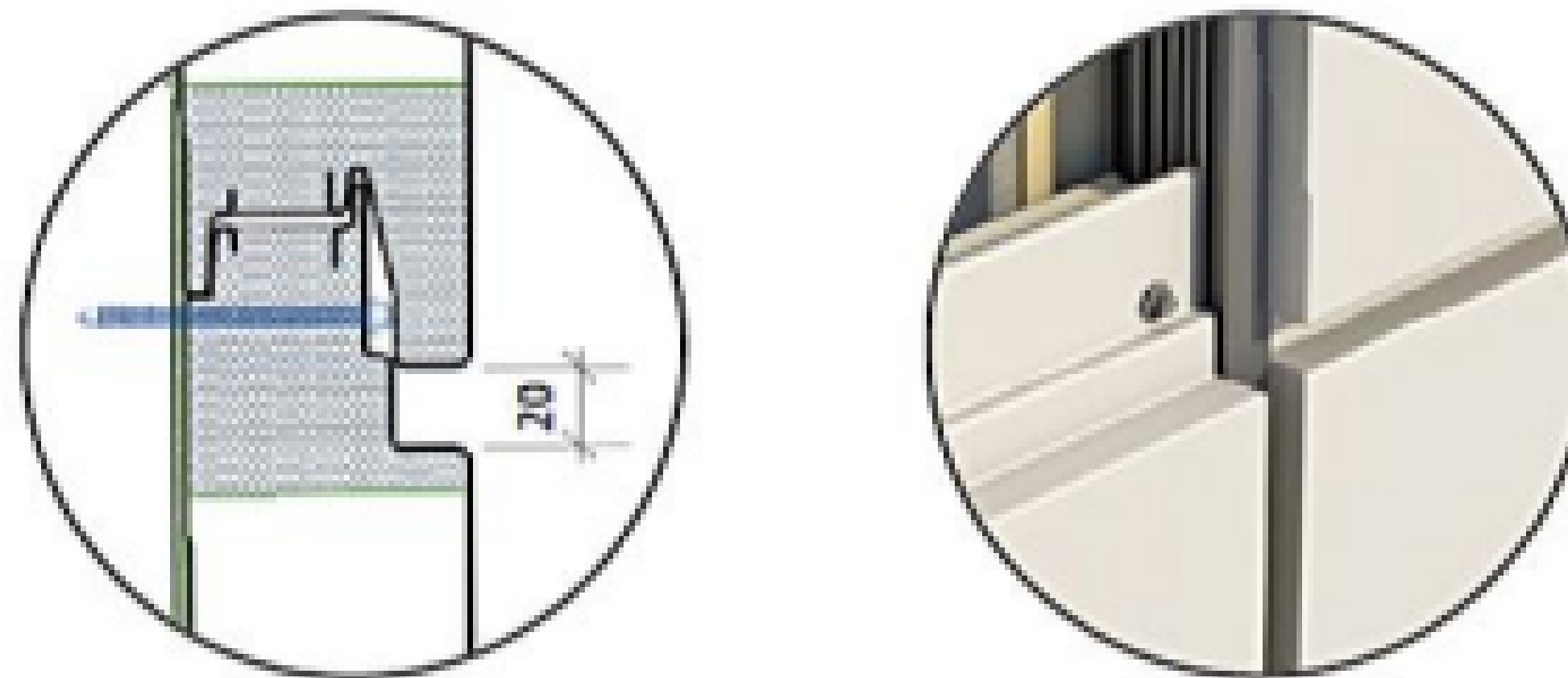

产品优点 PRODUCT ADVANTAGES

外表平坦、光滑、典雅, 强劲的金属质感。

优秀的隔热保温效果。

宽度尺寸灵活可选。

舌形咬槽式连接; 非硅化树脂嵌缝式连接。

施工工序简单; 优异的可操作性。

The surface is even, smooth and elegant, with an impressive metal texture.

Excellent thermal insulation effect

Products of different widths for choice

Tongue-and-groove connection and non-silicon resin caulking connection

Simple construction processes and excellent operability

产品参数 PRODUCT PARAMETERS

面板 Surface Plate	宽度 (mm) Width	建议长度 (mm) Suggestion Length		厚度 (mm) Thickness
		最小 Min	最大 Max	
彩钢板 PPGI		500	2500	
铝 Aluminum		500	2500	
不锈钢 Stainless steel	400-1000	500	2500	50/60/75/100
铜 Copper		500	2500	
黄铜 Brass		500	2500	

(829) 216-9224

Plaza Roaldi, local 308, El Millon, D.N.

✉ info@novasupplyrd.com

🌐 www.novasupplyrd.com

COLOR GOLD HIGH-QUALITY ROCK WOOL SANDWICH COMPOSITE PANEL

丽彩金® 高品质岩棉夹芯复合板



为建筑的高防火需求而生

针对建筑更高的防火需求，万事达推出高品质岩棉夹芯复合板产品—“丽彩金”，该产品以高品质憎水岩棉为芯材，通过超长精密双履带固化成型，在防火、保温、降噪、环保等方面具有卓越的表现。

Produced for meeting the high fire-proof requirement of buildings

In order to meet the higher fire-proof requirement of buildings, Wiskind has launched the high-quality rock wool sandwich composite panel "Color Gold". The product uses high-quality water-proof rock wool as the core material. Through the super long precision double-track curing, the product is excellent in terms of fire prevention, thermal insulation, noise reduction and environmental protection.

板型 PLATE TYPE

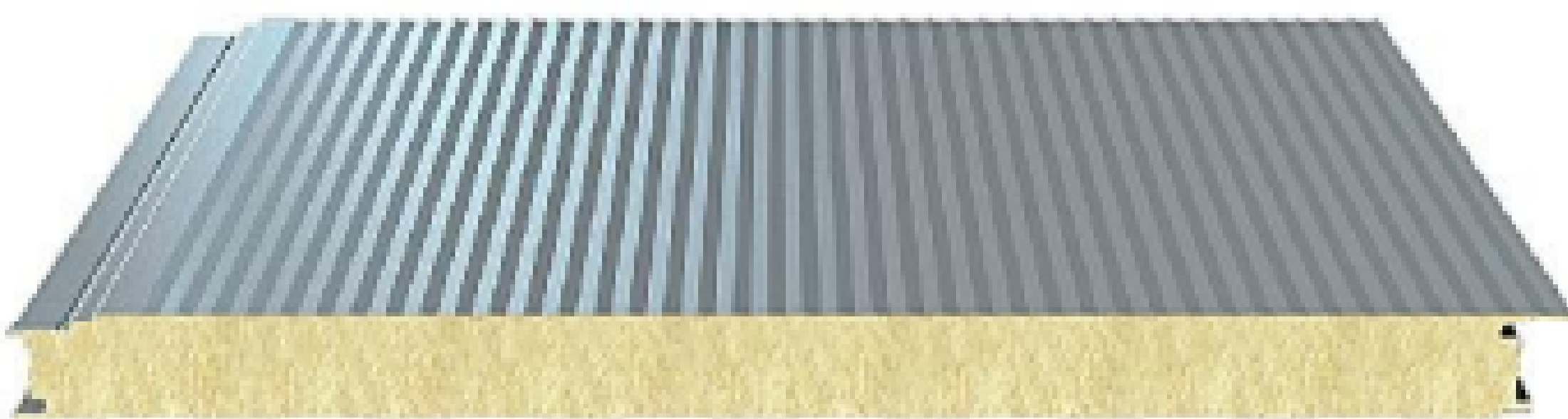

节点图 NODE FIGURE

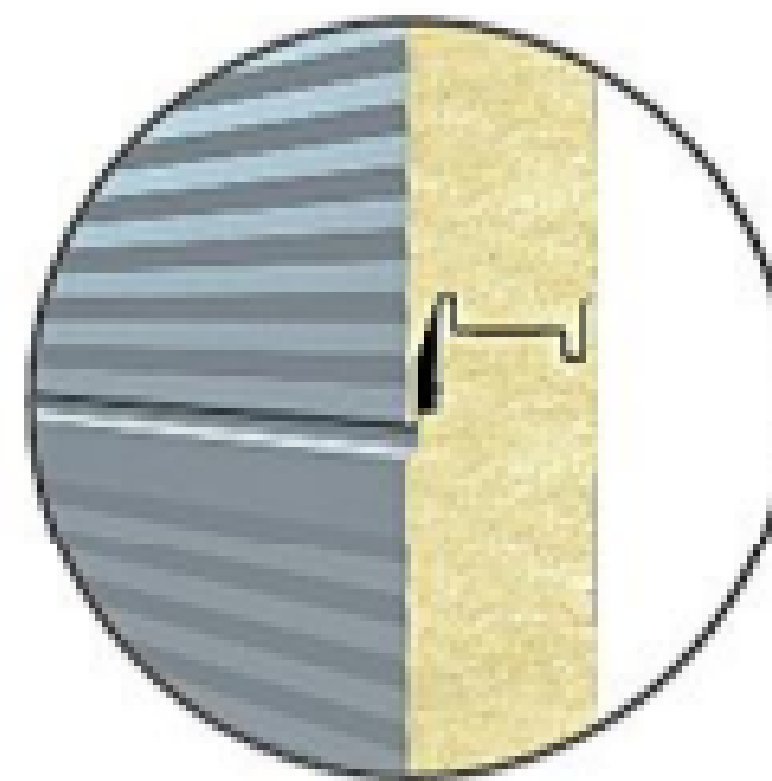

(829) 216-9224

Plaza Roaldi, local 308, El Millon, D.N.

✉ info@novasupplyrd.com

🌐 www.novasupplyrd.com

性能描述 PERFORMANCE DESCRIPTION

防火: 优选高品质憎水岩棉, A级防火。

保温: 岩棉导热系数低, 加之优秀的节点设计, 确保密封性能和保温效果。

隔音: 隔音性好, 隔声量 $\geq 30\text{dB}$, 有效降低外界噪声的干扰。

坚固: 板面强度高, 独有“双支撑”插接口设计, 抗负风压能力更强。

美观: 螺钉隐藏式节点设计, 板面效果多样。

Fire Prevention: high-quality water-proof rock wool and class-A fire-proof performance

Thermal Insulation: the low coefficient of heat conductivity and the excellent node design guarantee the sealing performance and the thermal insulation effect.

Sound Insulation: the sound insulation effect is good. The sound reduction factor is no less than 30dB. It can effectively reduce the interference of outside noise.

Solid: the panel has high strength, unique double-support plug interface design and strong capacity in wind pressure resistance.

Beautiful Design: the panel adopts hidden-screw node design and has diversified panel effects.

墙板使用跨度选用表 (控制变形不大于L/240) SPAN TABLE (MAXIMUM DEFORMATION $\leq L/240$)

厚 (mm) S(mm)	传热系数 (W/m ² ·K) Heat transfer coefficient	板面荷载 Panel load p=kn/m ²										
		0.6	0.8	1.0	1.2	1.5	0.6	0.8	1.0	1.2	1.5	
50	0.80	L=	2930	2740	2550	2330	2060	2590	2400	2100	2060	1800
80	0.54	L=	3900	3490	3190	2930	2510	3380	3000	2780	2510	2180
100	0.43	L=	4350	3860	3560	3230	2780	3680	3340	3080	2810	2400

注: 以上L 的单位为mm。上表计算取自外钢板0.6mm, 内钢板0.5mm, 岩棉容重 120 kg/m³。如有其它需求请与万事达技术中心联系

有效宽度 Effective width	1000mm
板面厚度 thick	50mm, 75mm, 100mm, 150mm
长度 length	可根据设计要求及运输安装条件确定

可选板面效果 AVAILABLE PANEL EFFECTS

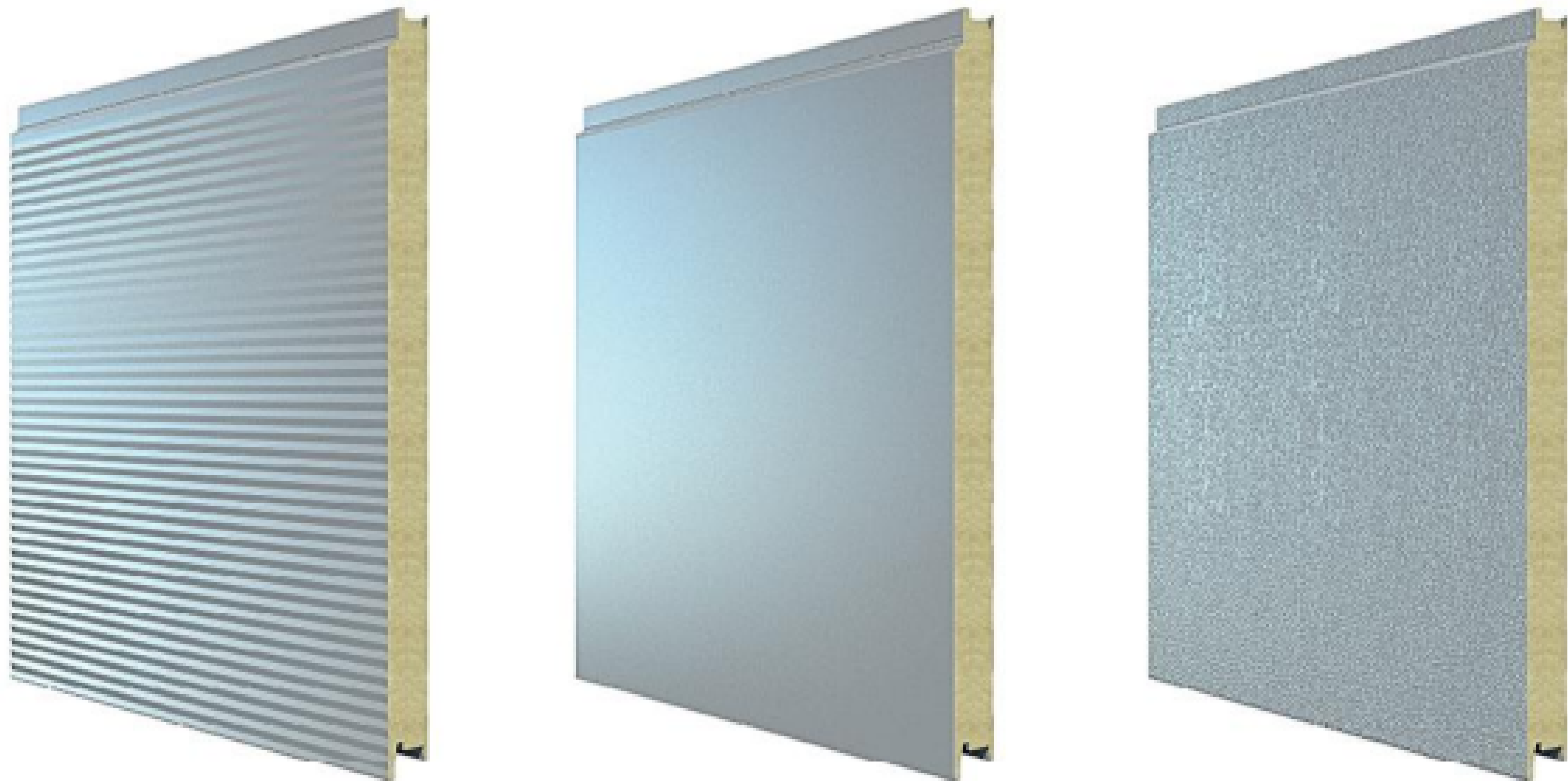

(829) 216-9224

Plaza Roaldi, local 308, El Millon, D.N.

✉ info@novasupplyrd.com

🌐 www.novasupplyrd.com

COLOR SPAR (PUR/PIR) PU SANDWICH COMPOSITE PANEL

丽彩晶® (PUR/PIR) 聚氨酯夹芯复合板



建筑节能的最佳解决方案

聚氨酯夹芯复合板作为一种绿色环保、节能高效、质轻强度高的新型建筑围护材料，在国外已经成为主流，但在国内普及率较低，为提高建筑保温效果，发展低碳经济，万事达积极响应国家节能减排的要求，引进欧洲先进的意大利 PUMA 连续生产线及生产工艺，实现专业化和规模化生产，推出具有欧洲品质、绿色环保的 (PUR/PIR) 聚氨酯夹芯复合板产品——“丽彩晶”。

The Best Solution to Energy Conservation of Buildings

As a green, environmental-friendly, light and high-strength new building cladding material, the PU sandwich composite panel has become a mainstream material overseas. However, its popularization rate is relatively lower in China. In order to improve the thermal insulation effect of buildings and develop low-carbon economy, Wiskind has actively responded to the national requirements on energy conservation and emission reduction, introduced advanced Italian PUMA continuous production lines and production technologies in Europe, realized professional and large-scale production, and launched Color Spar (PUR/PIR) PU sandwich composite panels with European quality and green environmental protection.

(829) 216-9224

Plaza Roaldi, local 308, El Millon, D.N.

✉ info@novasupplyrd.com

🌐 www.novasupplyrd.com

性能描述 PERFORMANCE DESCRIPTION

高效节能:卓越的保温性能,降低建筑耗能,减少空调装置的费用。

立面美观:隐钉式连接,螺钉不外露,建筑墙体更美观。

坚固耐用:板材强度高,墙体力学性能优越。

专利设计:独有“双支撑”插接口设计,抗负风压能力更强。

多样选择:多种板面效果选择。

High Efficiency and Energy Conservation: the excellent thermal insulation performance reduces building energy consumption and reduces costs on air-conditioning equipment. Beautiful Façade: the hidden nail connection guarantees hidden screws and more beautiful building walls. Solid and Durable: high-strength panels and excellent mechanical properties of walls. Patented Design: the unique double-support plug interface design ensures that walls have stronger wind pressure-resistant capacity and are solidier. Multiple Choices: multiple panel types.

3种板型可选 PLATE TYPE

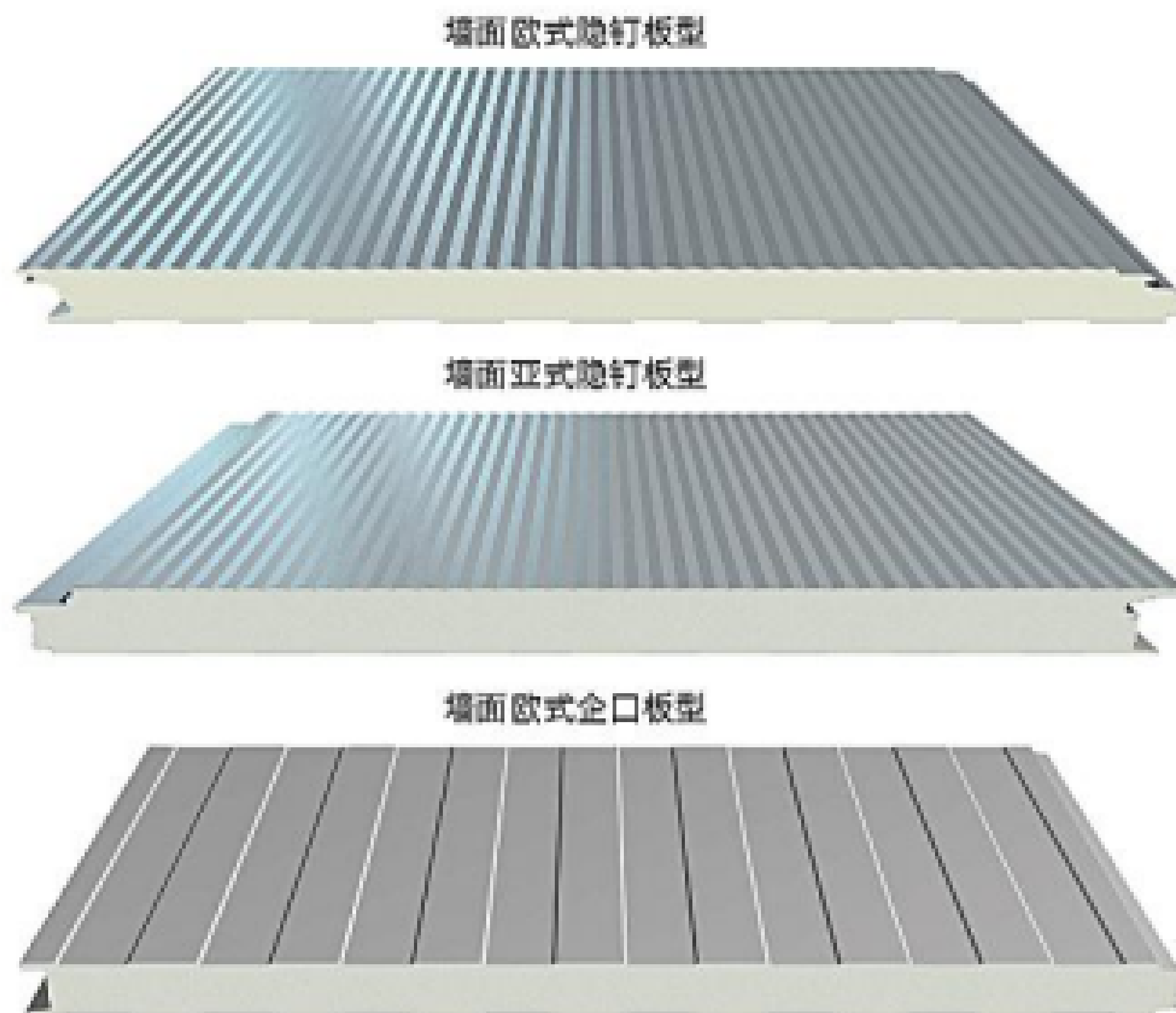

节点图 NODE FIGURE

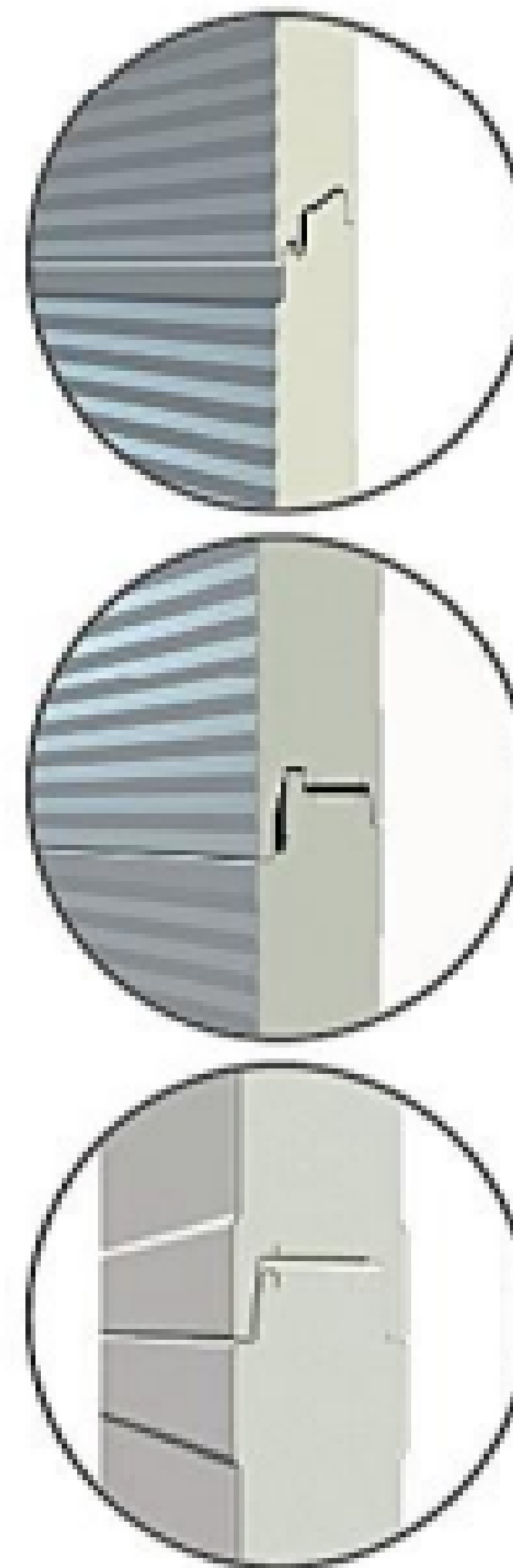

产品参数 PRODUCT PARAMETERS

板型 Panel Type	墙面欧式隐钉 European Joint Hidden Type Wall Panel	墙面亚式隐钉 Domestic Joint Hidden Type Wall Panel	墙面欧式企口 European Tongue and Groove Type Wall Panel
有效宽度 (mm) Effective width	1000	1000	930
芯材厚度 (mm) Core thickness	50、75、80、100、150等		
钢板推荐 Recommand	品牌Brand	宝钢、烨辉、马钢、博思格等Bao Steel, Yieh Phui Steel, Ma Steel, BHP Steel	
Steel Plates	涂层Painting	氟碳PVDF、SMP、HDP、PE;正面漆膜厚度25µm以上 PVDF, SMP, HDP, PE; The top painting should be above 25 µm	
	镀层Galvanized layer	外板:55%镀锌铝层100g/m ² 以上、镀锌层150g/m ² 以上 Exterior plate: 55% Aluzinc above 100g/m ² Or Zinc coating above 150g/m ² 内板:55%镀锌铝层70g/m ² 以上、镀锌层100g/m ² 以上 Inner Plate: 55% Aluzinc above 70g/m ² Or Zinc coating above 100g/m ² .	

丽彩晶节能墙面板荷载及传热系数 THE LOAD AND HEAT TRANSFER COEFFICIENT OF COLOR SPAR ENERGY-SAVING WALL PANELS

整板厚 Panel thick mm	传热系数 Heat transfer coefficient (W/m ² ·K)	板重 Weight kg/m ²	荷载分布 Load distribution												
			简支 (mm) Single support						连续 (mm) Continuous						
			P=kn/m ²	0.6	0.8	1.0	1.2	1.5	2.0	0.6	0.8	1.0	1.2	1.5	2.0
45	0.43	11.18	L=	3956	3445	3072	2784	2448	2046	4430	3858	3440	3118	2741	2291
50	0.39	11.38	L=	4268	3721	3323	3014	2655	2224	4780	4167	3721	3375	2973	2490
60	0.33	11.78	L=	4861	4246	3800	3453	3049	2564	5444	4755	4256	3867	3414	2871
75	0.26	12.38	L=	5688	4980	4464	4064	3599	3038	6370	5577	4999	4551	4030	3402
100	0.20	13.38	L=	6941	6087	5466	4984	4423	3746	7773	6817	6121	5582	4963	4195
120	0.16	14.18	L=	7853	6890	6189	5645	5013	4250	8795	7716	6931	6322	5614	4760
150	0.13	15.38	L=	9099	7980	7166	6534	5800	4913	10190	8937	8025	7318	6496	5502

(829) 216-9224

Plaza Roaldi, local 308, El Millon, D.N.

✉ info@novasupplyrd.com

🌐 www.novasupplyrd.com

COLOR POD ROCK WOOL/GLASS WOOL + PU SANDWICH PANEL

丽彩鼎® 岩棉/玻璃棉+聚氨酯侧封夹芯板

保温又防火,建筑围护界的全能担当

万事达凭借三十余年的金属围护系统行业经验自主研发,推出岩棉/玻璃棉+聚氨酯侧封夹芯复合板产品—丽彩鼎®,采用高品质彩色涂层钢板为面板,高品质憎水岩棉、玻璃棉为芯材,企口采用高密度硬质发泡聚氨酯填充,经过高压发泡固化、90°自动翻转密实布棉并由超长精密双履带控制成型。以其保温、防火、性能持久、安装便捷、外观雅致的优点,迅速成为工业建筑围护系统材料的主力军。

The thermal-insulated and fireproof product is excellent building cladding.

With experience in independent research and development of the metal cladding system in the past over 30 years, Wiskind has launched the Color Pod® rock wool/glass wool + pu sandwich panels which adopt high-quality colorful coated steel plates as surface plates, high-quality waterproof rock wool and glass wool as core materials. Its tongue-and-groove is filled by high-density rigid PU foam, goes through high-pressure foaming solidification and 90° automatic dense wool arrangement and realizes forming through super long precision double-track control. Due to its thermal insulated, fireproof and durable performance, convenient installation method and elegant appearance, it has rapidly become a main cladding system material for industrial buildings.

性能描述 PERFORMANCE DESCRIPTION

阻燃性能等级达到A级,提高了钢建筑整体的防火性能。

企口两侧以聚氨酯发泡填充,有效阻断热传导和雨水渗漏,防止芯材因吸潮降低强度和保温性能,使防火保温性能更持久。

高容重芯材使保温性能更佳(岩棉芯材容重 $\geq 120\text{kg/m}^3$,玻璃棉容重 $\geq 64\text{kg/m}^3$)。

企口两侧采取硬质聚氨酯发泡填充,增强整体强度,防止企口变形。

防火棉90度旋转,使棉纤维和板面成垂直状态,增强抗压抗拉强度50%以上。

The flame resistance level reaches the level A, which has improved the overall fireproof performance of steel buildings. The two edges of the tongue-and-groove is filled with polyurethane foams, which effectively stops heat conduction and rain leakage, prevents reduction of strength and thermal insulation performance caused by moisture absorption and makes fireproof and thermal insulation performance more durable. The high volumetric weight core material guarantees better thermal insulation performance (the volumetric weight of rock wool core materials $\geq 120\text{kg/m}^3$, the volumetric weight of glass wool $\geq 64\text{kg/m}^3$). The two edges of the tongue-and-groove is filled with rigid polyurethane foams to improve the overall strength and prevent deformation of the tongue-and-groove. The fireproof wool rotates 90° so that the wool fiber is perpendicular to the panel and the strength of pressure and tension resistance increases by 50%.

2种板型可选 PLATE TYPE

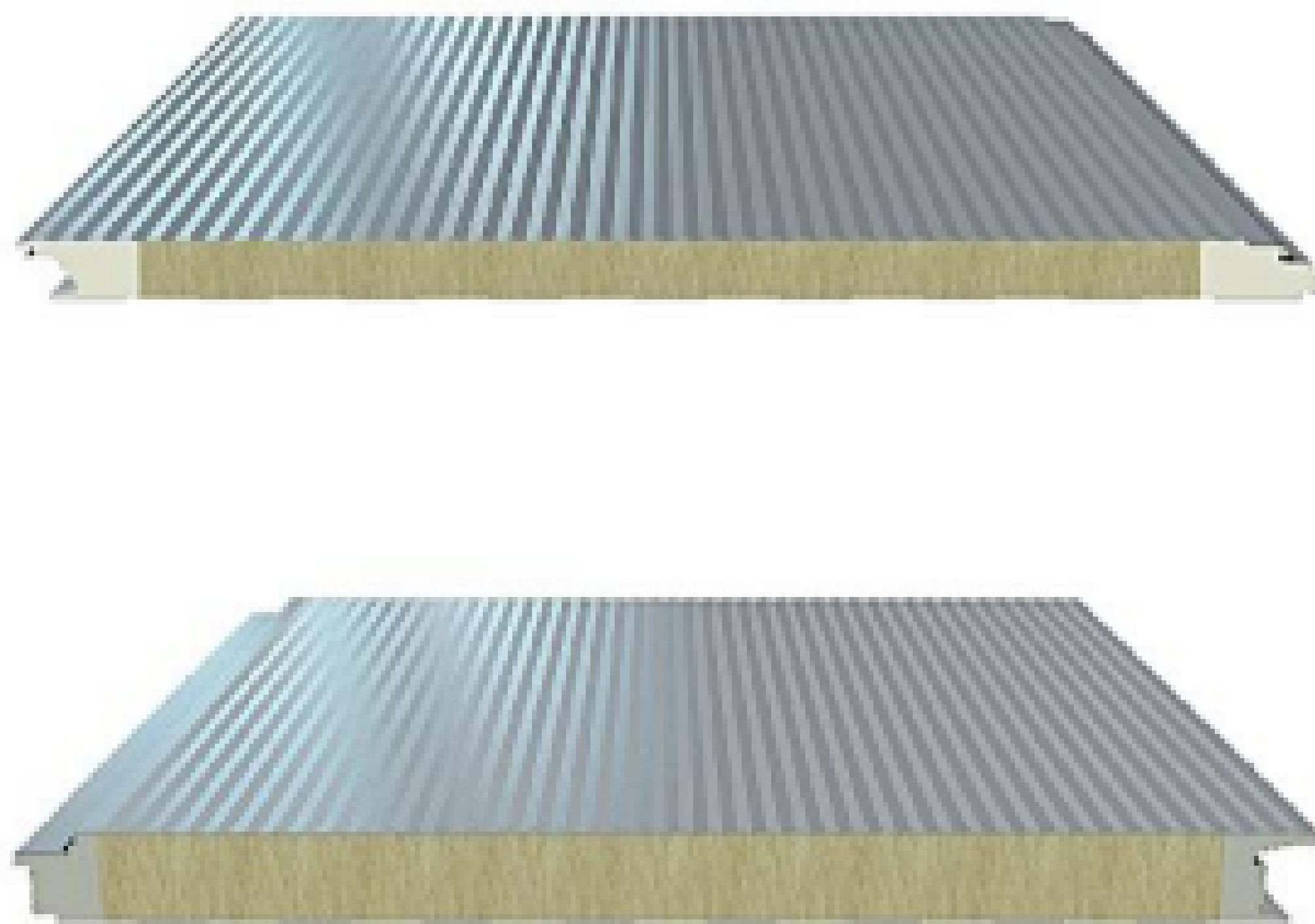

节点图 NODE FIGURE

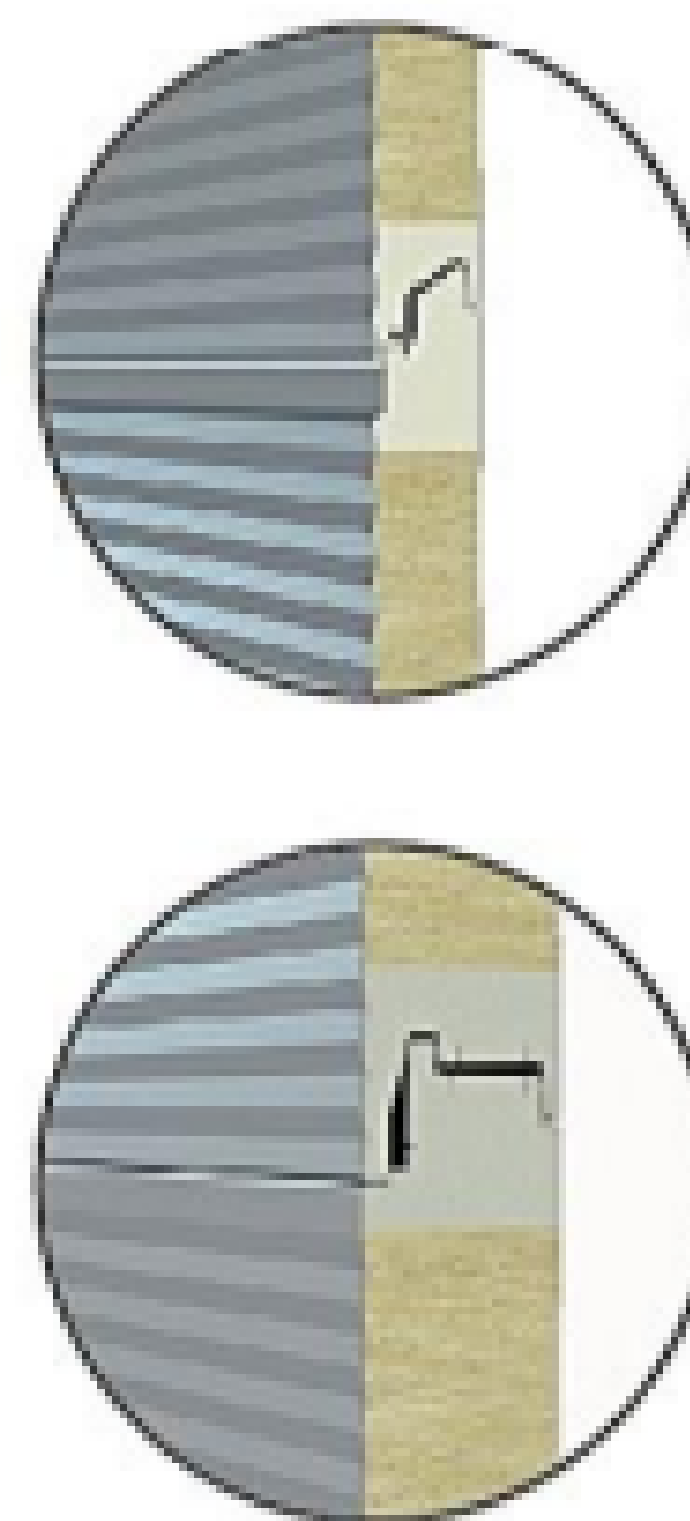

3种装饰缝可选



无装饰缝

20mm装饰缝

40mm装饰缝

(829) 216-9224

Plaza Roaldi, local 308, El Millon, D.N.

✉ info@novasupplyrd.com

🌐 www.novasupplyrd.com

多样板面效果可选 DIVERSE SIDE EFFECTS ARE OPTIONAL



V8波纹 V8 Corrugated Panel 丽水波纹 Lishui Corrugated Panel 平直压筋 Flat Ribbing Panel 光面纯平 Smooth Flat Panel 桔纹压花 Orange Peel Embossing Panel 丽彩压花 Shine Color Embossing Panels

产品参数 PRODUCT PARAMETERS

板型 Panel Type		墙面欧式隐钉 European Joint Hidden Type Wall Panel	墙面亚式隐钉 Domestic Joint Hidden Type Wall Panel
有效宽度 (mm) Effective width		1000	1000
芯材厚度 (mm) Core thickness		50、75、60、100等	
钢板推荐 Recommand Steel Plates	品牌Brand	宝钢、烨辉、马钢、博思格等Bao Steel, Yieh Phui Steel, Ma Steel, BHP Steel	
	涂层Painting	氟碳PVDF、SMP、HDP、PE; 正面漆膜厚度25μm以上 PVDF, SMP, HDP, PE; The top painting should be above 25 um	
	镀层Galvanized layer	外板: 55%镀锌锌层100g/m ² 以上、镀锌层150g/m ² 以上 Exterior plate: 55% Aluzinc above 100g/m ² Or Zinc coating above 150g/m ² 内板: 55%镀锌锌层70g/m ² 以上、镀锌层100g/m ² 以上 Inner Plate: 55% Aluzinc above 70g/m ² Or Zinc coating above 100g/m ² .	

丽彩鼎防火墙面板(岩棉芯材)荷载及传热系数

整板厚 Panel thick mm	传热系数 Heat transfer coefficient (W/m ² ·K)	板重 Weight kg/m ²	荷载分布 Load distribution												
			简支 (mm) Single support						连续 (mm) Continuous						
			P=kn/m ²	0.6	0.8	1.0	1.2	1.5	2.0	0.6	0.8	1.0	1.2	1.5	2.0
50	0.80	15.13	L=	4207	3655	3254	2942	2581	2148	4711	4093	3644	3295	2890	2405
75	0.53	17.94	L=	5609	4894	4373	3969	3500	2936	6282	5481	4897	4445	3920	3288
100	0.41	20.75	L=	6840	5977	5349	4862	4296	3614	7660	6694	5990	6556	4811	4047

以上数值取自外钢板0.6mm,内钢板0.5mm, 岩棉容重120kg/m³。

丽彩鼎防火墙面板(玻璃棉芯材)荷载及传热系数

整板厚 Panel thick mm	传热系数 Heat transfer coefficient (W/m ² ·K)	板重 Weight kg/m ²	荷载分布 Load distribution												
			简支 (mm) Single support						连续 (mm) Continuous						
			P=kn/m ²	0.6	0.8	1.0	1.2	1.5	2.0	0.6	0.8	1.0	1.2	1.5	2.0
50	0.69	12.61	L=	4291	3746	3349	3042	2684	2254	4850	4195	3750	3407	3006	2524
75	0.47	14.16	L=	5711	5004	4490	4091	3627	3067	6396	5604	4491	5605	4062	3435
100	0.36	15.71	L=	6959	6106	5486	5005	4445	3770	7794	6838	6144	5605	4978	4222

以上数值取自外钢板0.6mm,内钢板0.5mm, 玻璃棉容重64kg/m³。



(829) 216-9224

Plaza Roaldi, local 308, El Millon, D.N.

✉ info@novasupplyrd.com

🌐 www.novasupplyrd.com

SPECIAL RECOMMENDATION V8 WAVE SERIES (PATENTED PRODUCT)

特别推荐 V8波纹(专利产品)

板面造型简洁时尚、典雅大方、层次感、立体感强；营造出富有韵律的光影效果。

The panel is simple, fashionable, elegant and graceful and has graduated layers and a strong three-dimensional sense to create a rhythmic effect of light and shadow.

板型PLATE TYPE (外观专利号:ZL 2001 3 0108109.4)

连接示意图 CONNECTION DIAGRAM

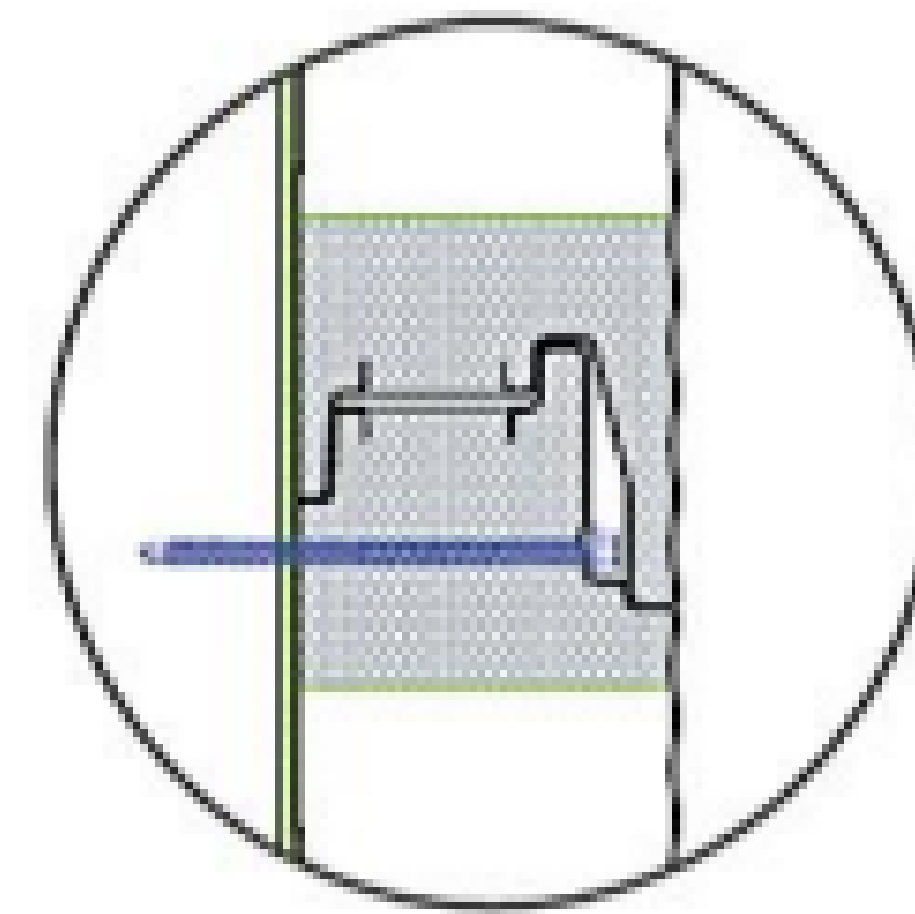
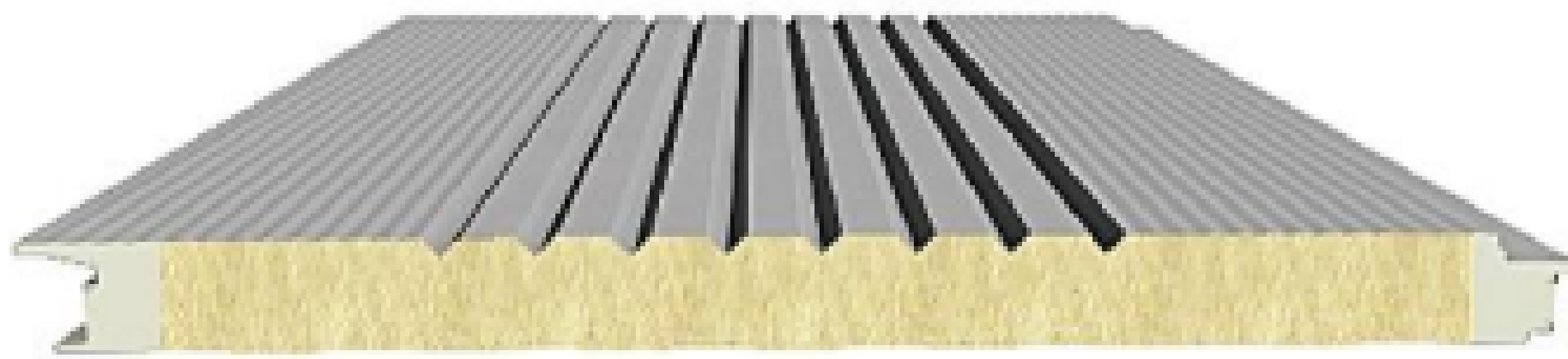

节点图 NODE FIGURE

板型优势 PLATE ADVANTAGE

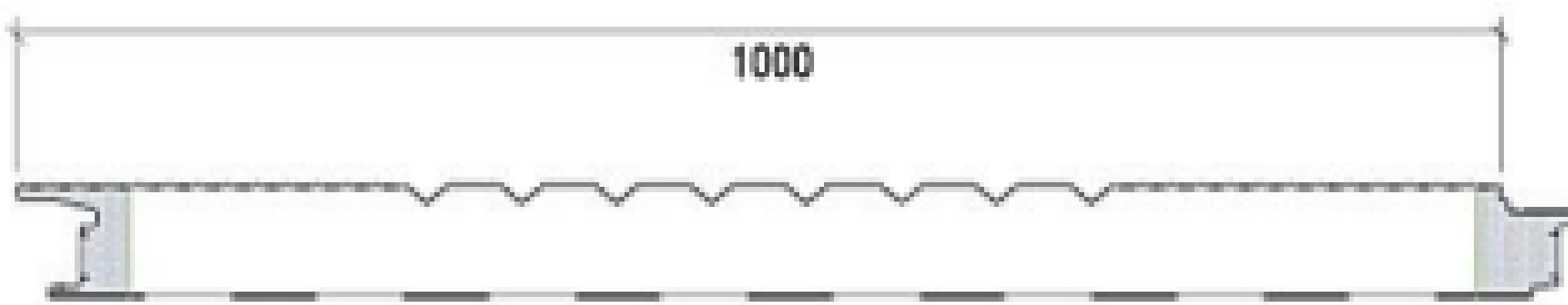

- 同一板面双重表现效果, 营造出富有旋律的光影效果。
- 八个V型深槽加筋, 板面强度更高。
- 专利外观产品, 只为与众不同的你。
- The same board performance double effect, creating a rich melody of light.
- Eight V-shaped deep trench reinforcement, higher board strength.
- Patented product appearance, just for your uniqueness.

产品参数 PRODUCT PARAMETERS

有效宽度	1000mm
厚度	50mm/75mm/100mm/150mm
长度	可根据设计要求及运输安装条件确定

(829) 216-9224

Plaza Roaldi, local 308, El Millon, D.N.

✉ info@novasupplyrd.com

🌐 www.novasupplyrd.com

EUROPEAN ROOFING LAP OF THE ROOFING SYSTEM

屋面系统 屋面欧式搭接

板型 PLATE TYPE

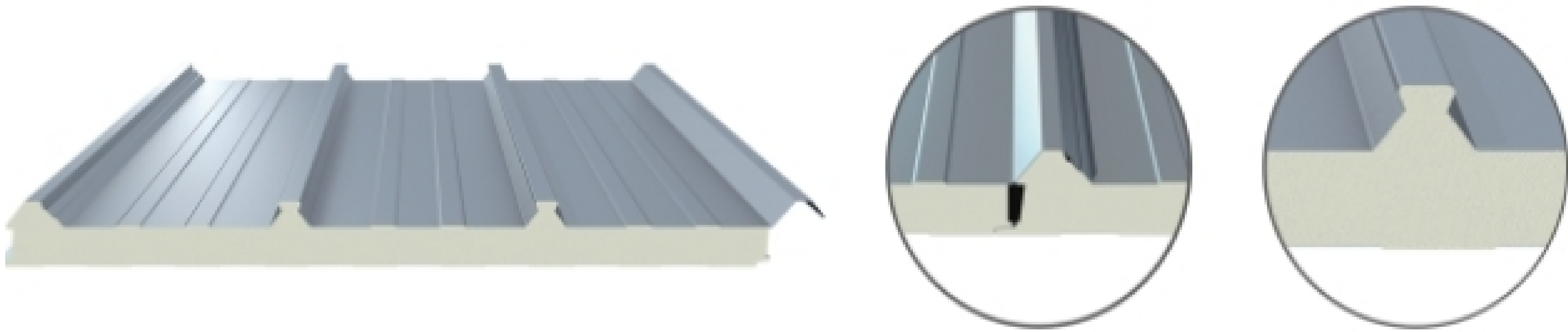

板型升级 PANEL UPGRADE

屋面板波峰构造升级，可直接固定夹具，轻松安全的实现屋面光伏太阳能等系统的安装，提升屋面的有效利用率。

Roof Panel wave structure upgrade, can fix clamp directly, that makes installation of roofing photovoltaic solar and other systems easy and safe, promote effective utilization rate of roof.

板型优势 PANEL TYPE ADVANTAGES

搭接母口边采用叠边工艺处理，搭接更严密，避免边部因无涂层锈蚀，延长了板材的使用寿命，增加了强度。另一方面避免了对施工人员造成的伤害。波峰高34mm三波峰设计提高了屋面板的承载力，减少了屋面檩条的使用量，增强荷载能力，兼具平衡流水作用。离水槽设计，防止渗水现象发生。

The concave edge of the lap joint adopts the lapping technique so the lapping is tighter, avoids rusty edges caused by no coating, extends the service life of panels and increases the strength. On the other hand, it prevents constructors from damage. The crest wave height is 34 mm. The three-crest wave design has improved the bearing capacity of roof panels, reduced the amount of roof purlines, improved the bearing capacity and balanced the running water action. The design of water tanks prevents water leakage.

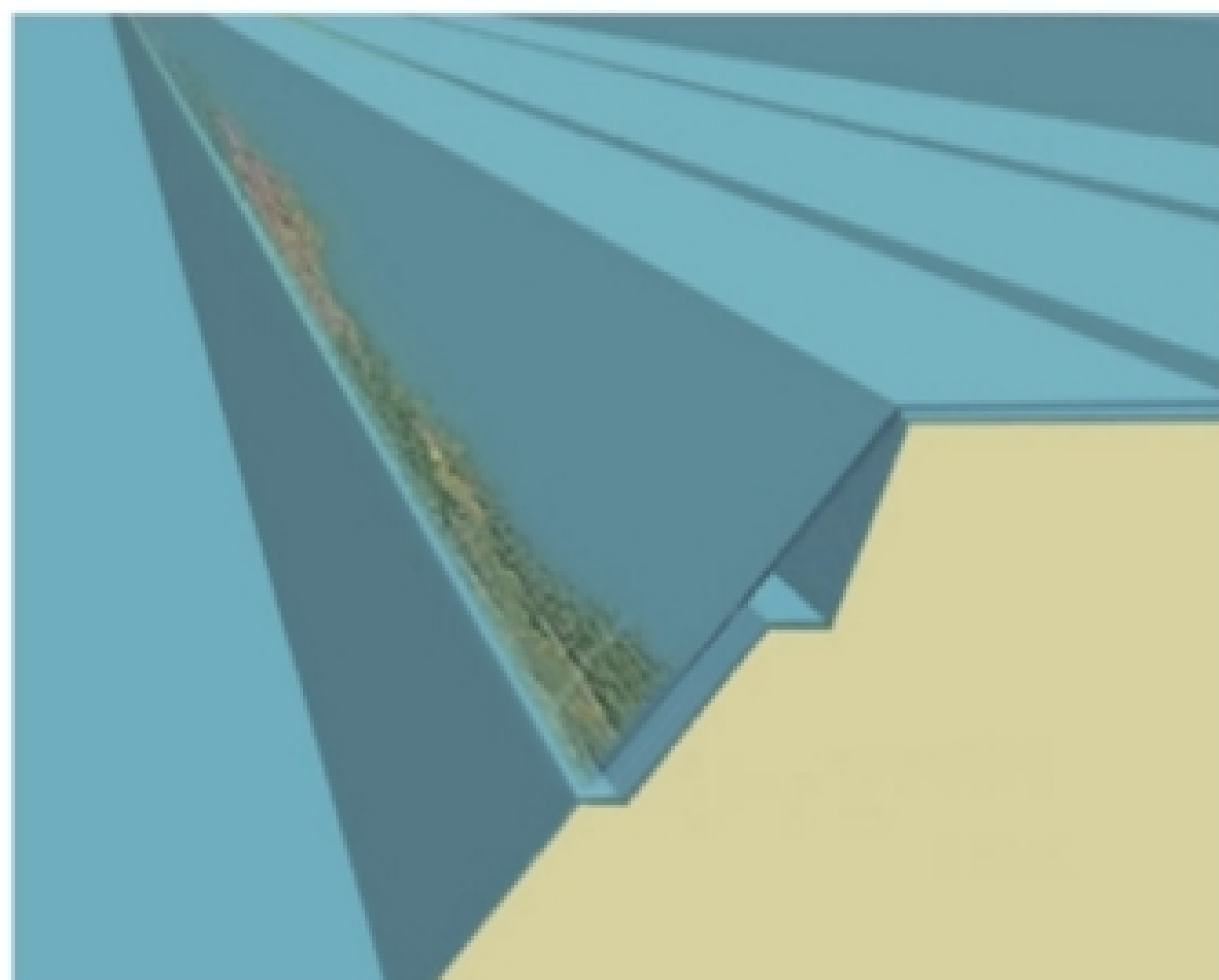

无叠边设计，雨水浸湿后，端部因无涂层锈蚀，影响屋面寿命
Without lapping design, the edge is corroded for the lack of coating after being soaked by rainwater, which shortens the service life of roofing.

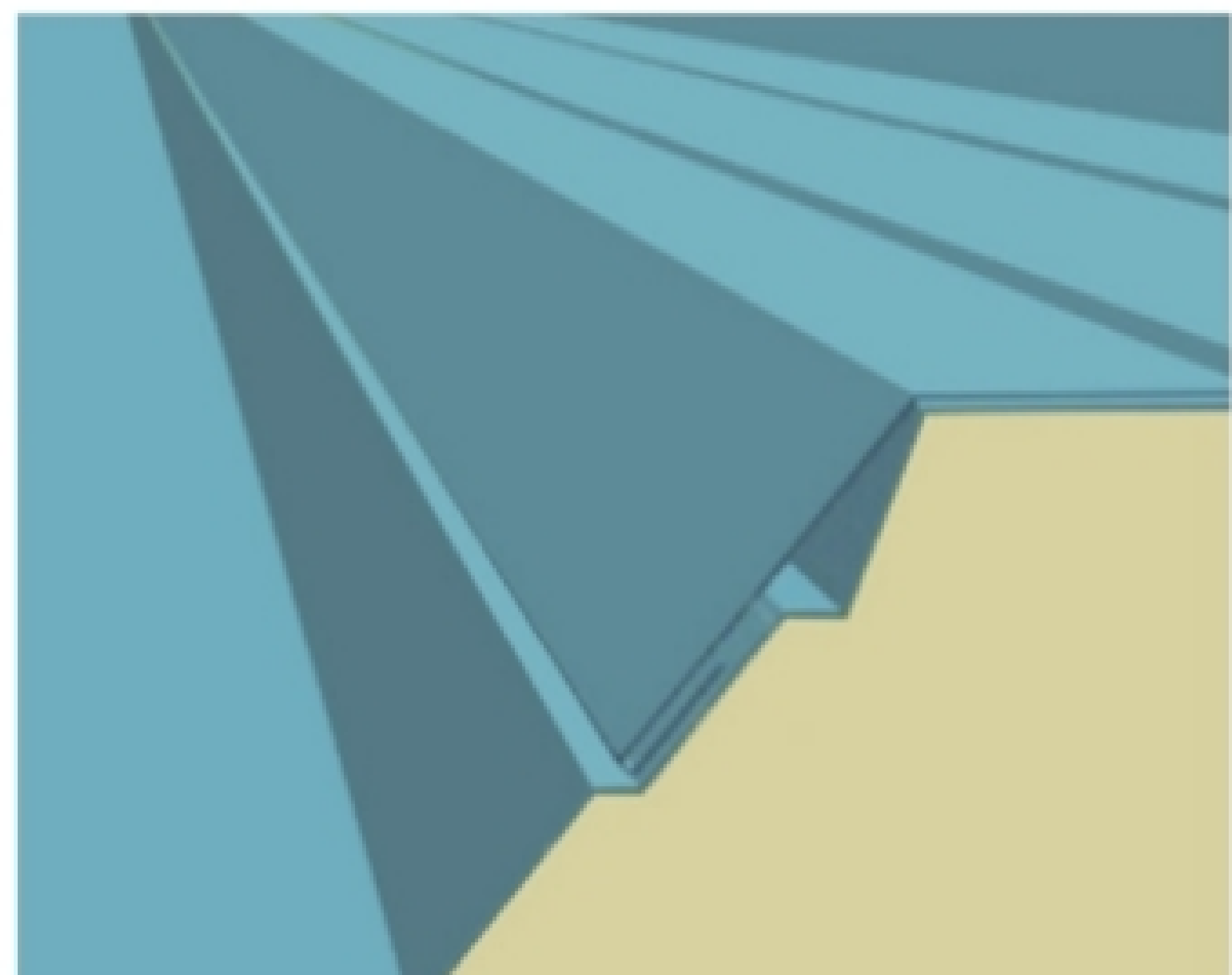

叠边设计，搭接更紧密，保护无涂层的端部，提升屋面寿命
The lapping design features a closer lapping effect, protects the edges without coating and improves the service life of roofing.

(829) 216-9224

Plaza Roaldi, local 308, El Millon, D.N.

✉ info@novasupplyrd.com

🌐 www.novasupplyrd.com

EUROPEAN HIDDEN NAILS OF THE ROOFING SYSTEM

屋面系统 屋面欧式隐钉

板型优势 PLATE ADVANTAGE

螺钉隐藏,防水性极佳,防止了螺钉的锈蚀,同时避免了冷桥现象的发生。
波峰高40mm三波峰设计提高了屋面板的承载力,减少了屋面檩条的使用量,增强荷载能力,兼具平衡流水作用。

The hidden screws guarantee excellent waterproof performance and prevent screw corrosion and thermal bridge phenomena. The crest wave height is 34 mm. The three-crest wave design has improved the bearing capacity of roof panels, reduced the amount of roof purlines, improved the bearing capacity and balanced the running water action.

板型升级 PLATE UPGRADE

屋面板波峰构造升级,可直接固定夹具,轻松安全的实现屋面光伏太阳能等系统的安装,提升屋面的有效利用率。

Roof Panel wave structure upgrade, can fix clamp directly, that makes installation of roofing photovoltaic solar and other systems easy and safe, promote effective utilization rate of roof.

板型 PLATE TYPE

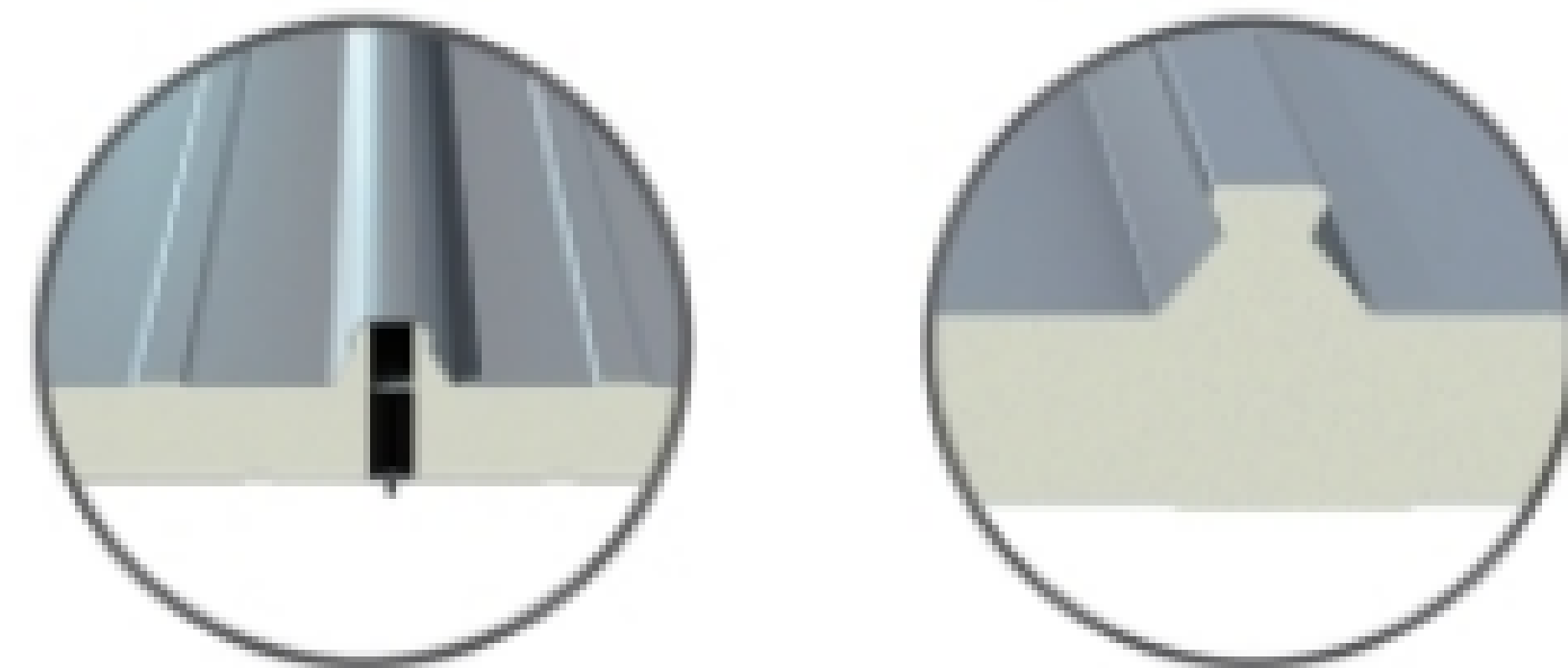
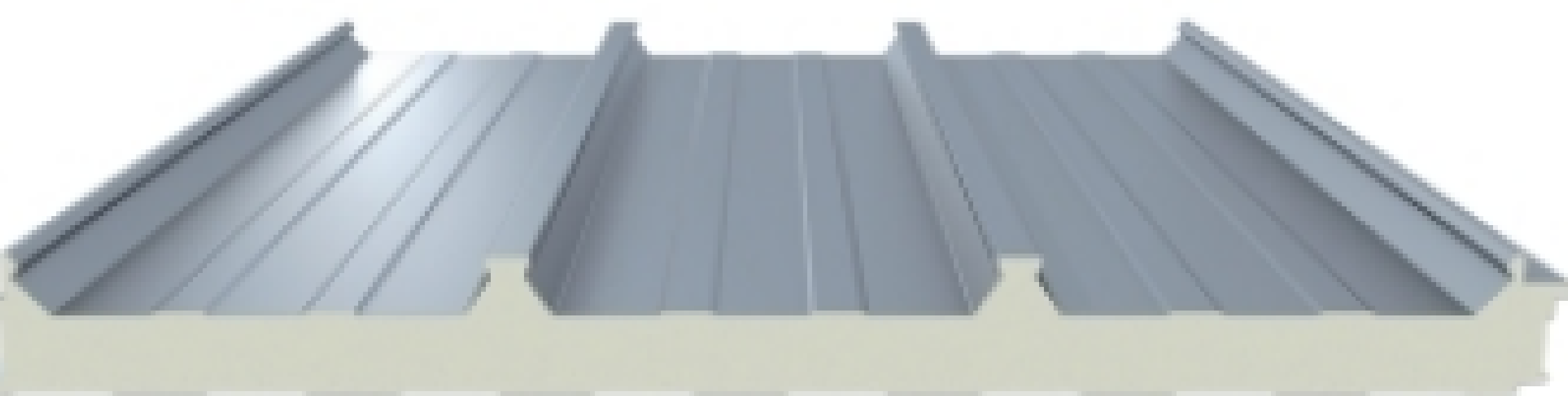

产品参数 PRODUCT PARAMETERS

板型 Panel Type	屋面欧式隐钉		屋面欧式搭接	
有效宽度 (mm) Effective width	930		1000	
波峰高度 (mm)	40		34	
芯材类别	PUR / PIR / 岩棉+PUR / 玻璃棉+PUR			
芯材厚度 (mm) Core thickness	50、75、80、100等			
钢板推荐	品牌 Brand	宝钢、烨辉、马钢、博思格等 Bao Steel, Yieh Phui Steel, Ma Steel, BHP Steel		
Recommand Steel Plates	涂层 Painting	氟碳PVDF、SMP、HDP、PE; 正面漆膜厚度25μm以上 PVDF, SMP+HDPPE; The top painting should be above 25 um		
	镀层 Galvanized layer	外板: 55%镀锌铝锌镀层100g/m ² 以上、镀锌镀层150g/m ² 以上 Exterior plate: 55% Aluzinc above 100g/m ² Or Zinc coating above 150g/m ² 内板: 55%镀锌铝锌镀层70g/m ² 以上、镀锌镀层100g/m ² 以上 Inner Plate: 55% Aluzinc above 70g/m ² Or Zinc coating above 100g/m ² .		

本表仅供参考,具体工程应用请与万事达联系

丽彩鼎防火屋面板(岩棉芯材)荷载及传热系数

整板厚 Panel thick mm	传热系数 Heat transfer coefficient (W/m ² -K)	板重 Weight kg/m ²	荷载分布 Load distribution												
			简支 (mm) Single support						连续 (mm) Continuous						
			P=kn/m ²	0.6	0.80	1.0	1.2	1.5	2.0	0.6	0.8	1.0	1.2	1.5	2.0
50	0.64	13.08	L=	4520	3975	3580	3273	2916	2484	5062	4452	4009	3665	3265	2782
75	0.43	14.63	L=	5631	4931	4421	4026	3566	3012	6306	5522	4951	4509	3993	3373
100	0.32	16.18	L=	6639	5798	5186	4711	4159	3995	7435	6493	5808	5276	4658	3914

(829) 216-9224

Plaza Roaldi, local 308, El Millon, D.N.

✉ info@novasupplyrd.com

🌐 www.novasupplyrd.com

万事达® 冷库板围护系统

COLD ROOM PANEL CLADDING SYSTEM



(829) 216-9224

Plaza Roaldi, local 308, El Millon, D.N.

✉ info@novasupplyrd.com

🌐 www.novasupplyrd.com

COLD ROOM PANEL CLADDING SYSTEM

冷库板围护系统

万事达聚氨酯冷库板是以轻质聚氨酯硬泡为芯材,彩钢板或不锈钢板为面材组合而成的新型复合板,具有导热系数低、耐荷性好、闭孔率高、阻燃性能优异、耐温范围广的优势,可有效防止冷库库体因内外温差较大导致冷量的传播,从而使冷库更加节能,提高冷库的工作效率,主要适用于食品、屠宰、医药、冷链物流等行业。

The Wiskind polyurethane cold room panel is a new composite panel which takes light rigid polyurethane foams as the core material and colorful steel plates or stainless steel plates as the surface material. The new composite panel has advantages such as a low heat conductivity coefficient, good load resistance performance, a high percentage of close area, excellent flame resistance performance and a wide scope of temperature resistance, can effectively prevent cold energy transmission due to the larger temperature difference between the inside and the outside so cold rooms are more energy-saving and the working efficiency of cold rooms is improved. It is mainly used in the food, slaughter, medicine, cold chain logistics and other industries.



COLD ROOM CONTAINMENT SYSTEM



(829) 216-9224

Plaza Roaldi, local 308, El Millon, D.N.

✉ info@novasupplyrd.com

🌐 www.novasupplyrd.com

凹凸槽双插口型 CONCAVE-CONVEX TYPE

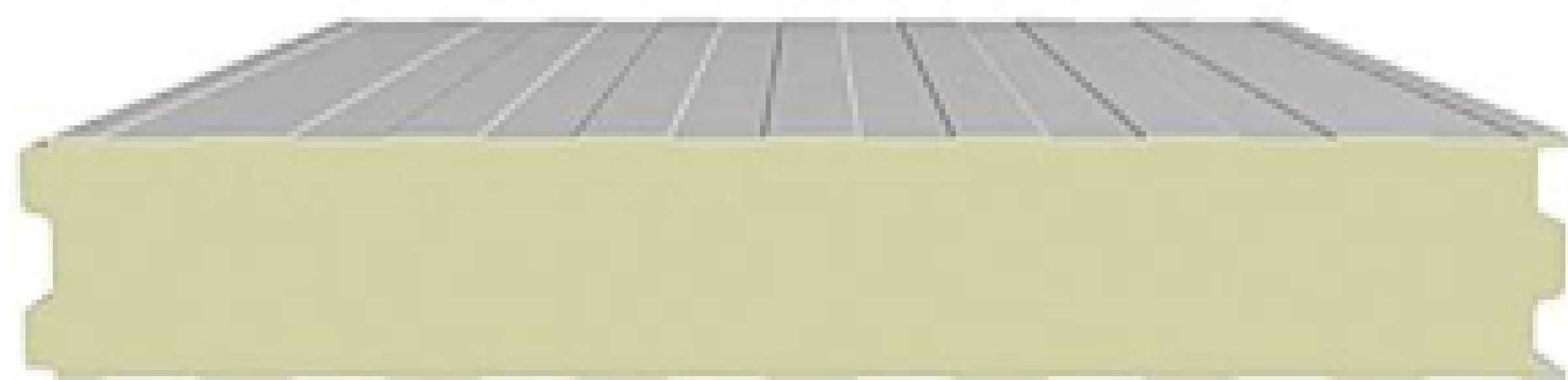

插接口 PLUG TYPE

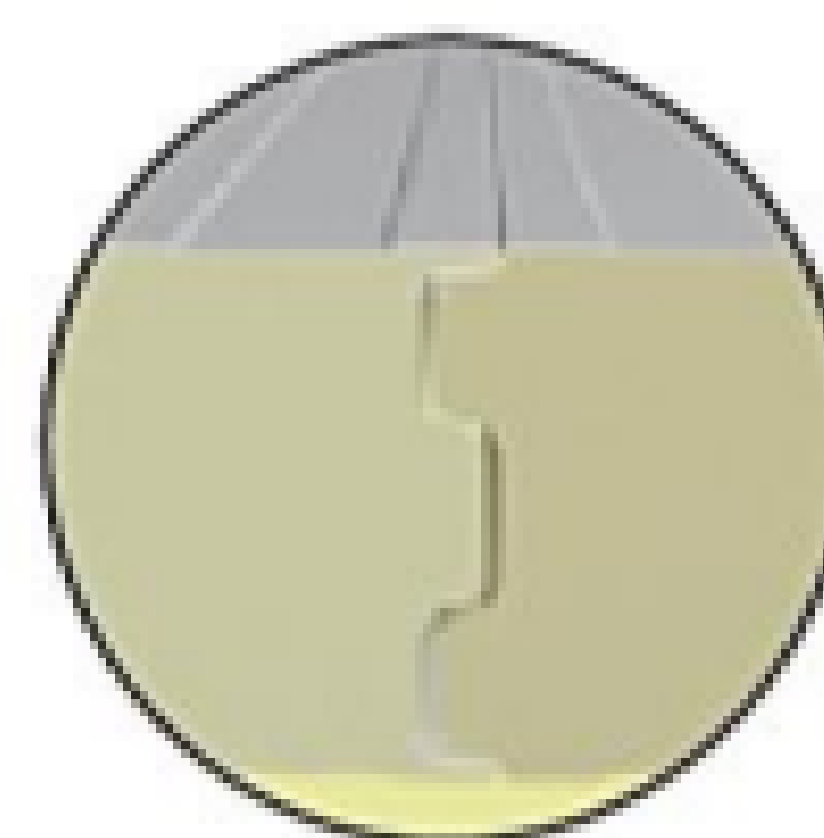

普通插口型 SOCKET TYPE



插接口 PLUG TYPE

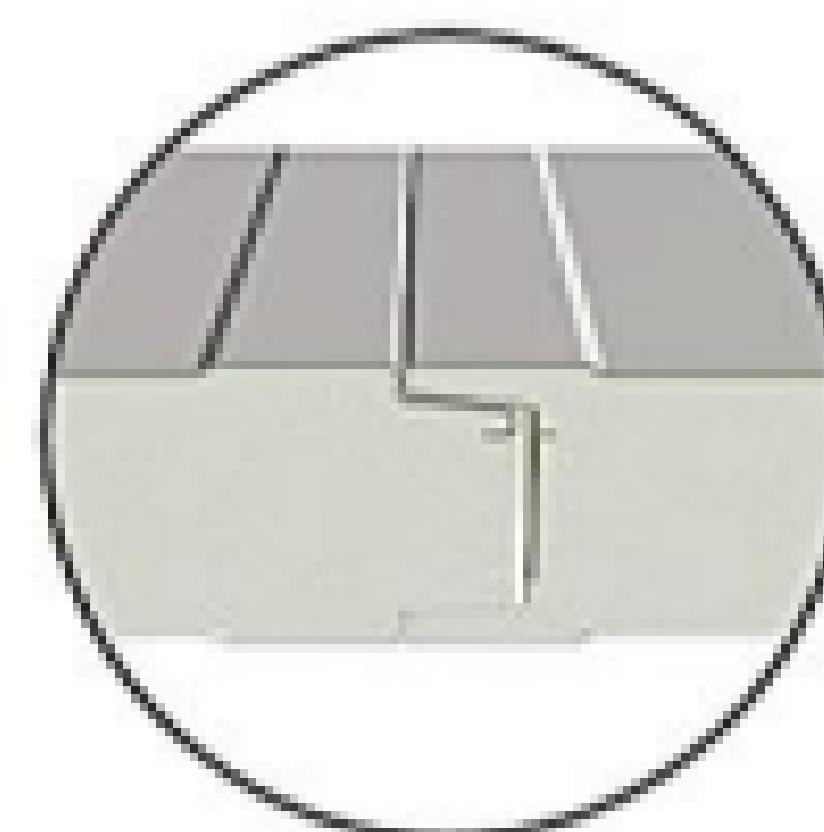

性能描述 PERFORMANCE DESCRIPTION

采用独特的凹凸槽插接方式,提高了板材插口处的密闭性;
板材均匀稳固,尺寸稳定性好;
高效保温隔热,防水效果佳,绿色环保;
施工方便,安装快捷。

It adopts the unique concave-convex type which improves the tightness of the socket of the panel.
The panel is even and stable. The dimensional stability is good. It has a high-efficient thermal insulation effect and an excellent waterproof effect. It is a green and environmental-friendly product, construction and installation of which are convenient and rapid.

相关参数 PARAMETERS

产品型号	有效覆盖宽度(mm)	钢板厚度(mm)	芯材厚度(mm)	钢板选择(mm)
WSD-930	930	0.4-0.8	50、75、100、120、150、180、200	彩涂板、不锈钢、彩铝板
WSD-1000	1000	0.4-0.8	50、75、100、120、150、180、200	

(829) 216-9224

Plaza Roaldi, local 308, El Millon, D.N.

✉ info@novasupplyrd.com

🌐 www.novasupplyrd.com

万事达® 岩棉夹芯防火板系统
ROCK WOOL SANDWICH FIRE-PROOF PANEL SYSTEM



(829) 216-9224

Plaza Roaldi, local 308, El Millon, D.N.

✉ info@novasupplyrd.com

🌐 www.novasupplyrd.com

METAL SURFACE SANDWICH PANEL SYSTEM

岩棉夹芯防火板系统

万事达岩棉夹芯防火板系统,通过工厂专业自动化的设备将岩棉和钢板复合成一个整体,从而改变了以前岩棉板材需现场复合的方式,在满足建筑物保温隔热、隔声、防火等要求的前提下,更达到了优质、高效、可靠、安全的目标。

The Wiskind rock wool sandwich fireproof system, through professional factory automation equipment will rock wool and steel composite into a whole, so as to change the scene of the rock wool plate needs before composite, in building heat preservation and heat insulation, sound insulation, fire prevention requirements under the premise of more reach the goal of high quality, efficient, reliable and safe.

万事达推荐您优选高品质“憎水岩棉”:

憎水率≥98%, 板面更稳定

不产生腐蚀性物质

防火性更佳

Wiskind recommends the high-quality "waterproof rock wool" to you:

The waterproof rate is not less than 98% and the panel surface is more stable.

It does not produce corrosive substances.

It has good performance of fire prevention.

950岩棉防火屋面板

950 METAL ROCK WOOL ROOFING COMPOSITE PANELS

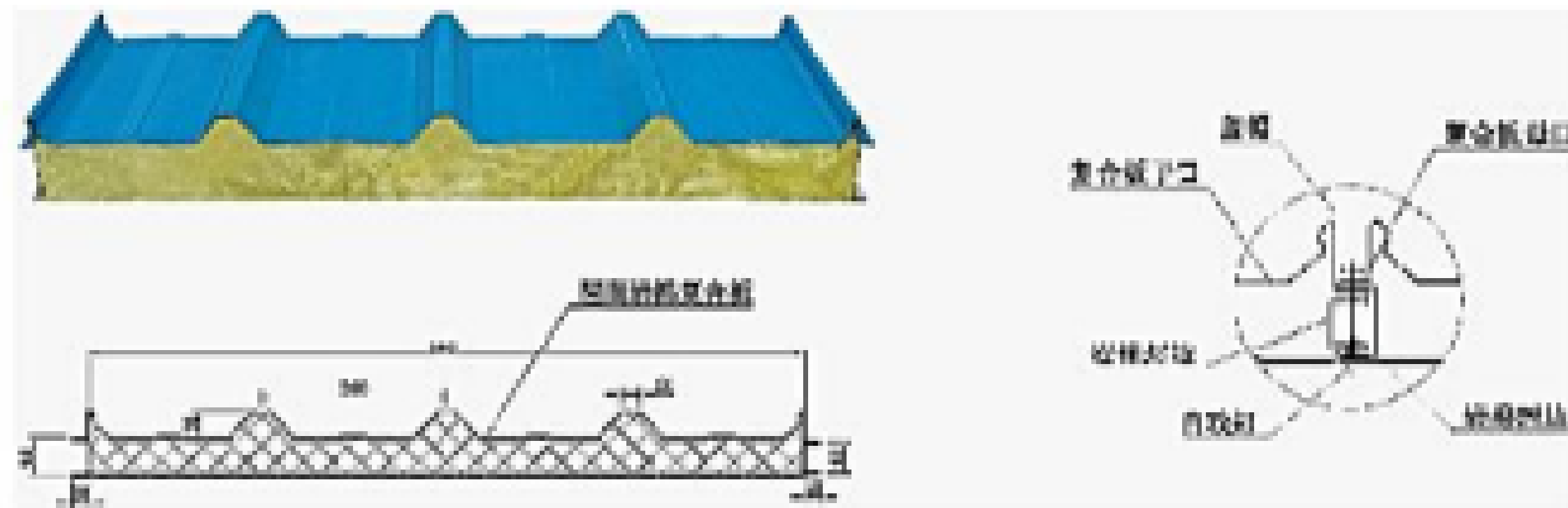

950/1150岩棉防火墙面板

950/1150 ROCK WOOL SANDWICH WALL PANEL



屋面板 ROOF BOARD

厚度 (mm) Thickness(mm)	50	75	100	150	200
板重 (kg/m ²) Panel Weight(km/m ²)	0.169	0.201	0.232	0.29	0.360
有效宽度 (mm) Effedwidth(mm)					950
长度 (mm) Length(mm)	长度任意, 限于运输条例, 一般<15000 Lenth is subject to tranportion. Normally less than 15000				

墙面 ROOF BOARD

厚度 (mm) Thickness(mm)	50	75	100	150	200
板重 (kg/m ²) Panel Weight(km/m ²)	0.159	0.191	0.223	0.287	0.351
有效宽度 (mm) Effedwidth(mm)					950
长度 (mm) Length(mm)	长度任意, 限于运输条例, 一般<15000 Lenth is subject to tranportion. Normally less than 15000				

(829) 216-9224

Plaza Roaldi, local 308, El Millon, D.N.

✉ info@novasupplyrd.com

🌐 www.novasupplyrd.com

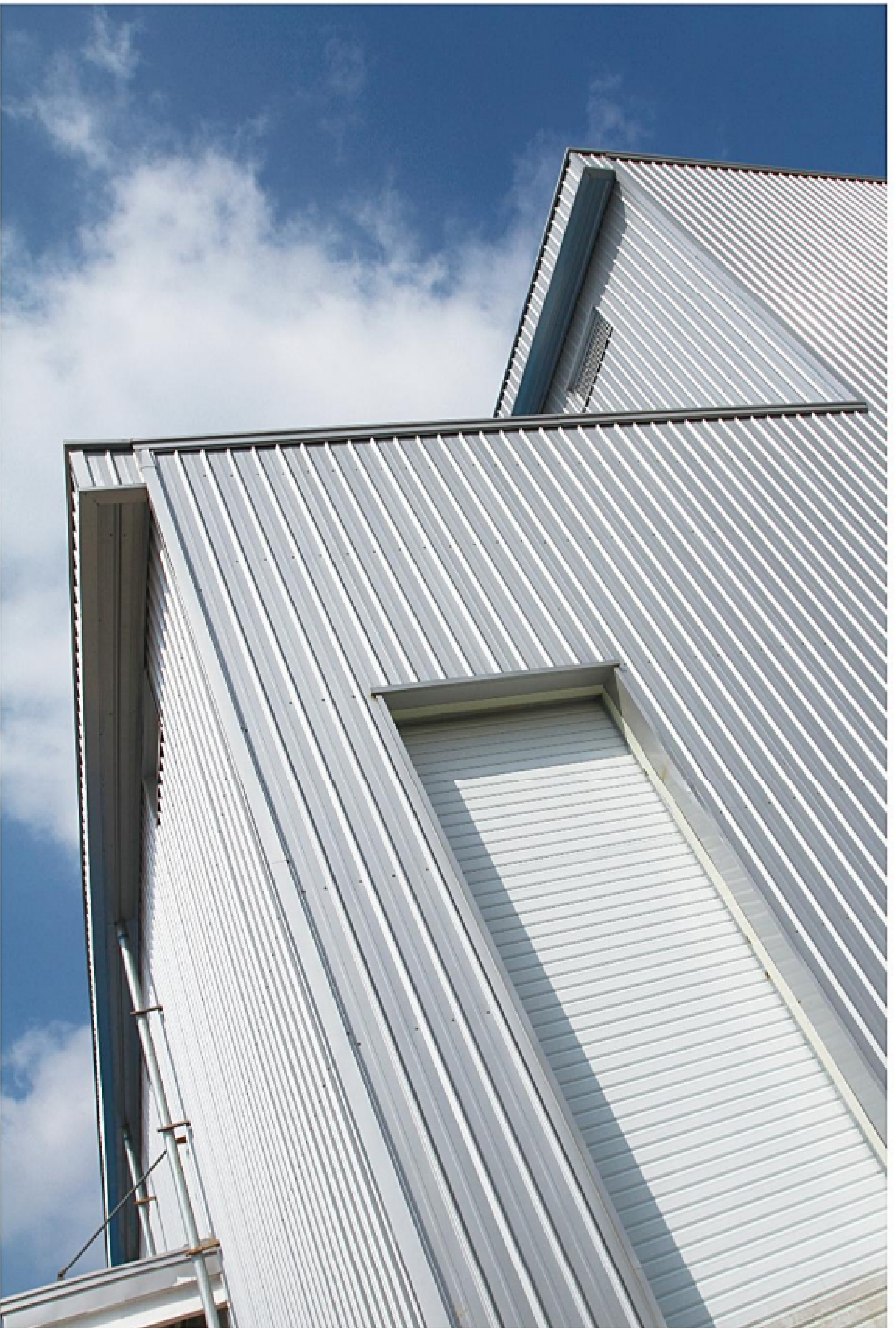

万事达® 预制金属板系统

PREFABRICATED METAL PANEL SYSTEM



(829) 216-9224

Plaza Roaldi, local 308, El Millon, D.N.

✉ info@novasupplyrd.com

🌐 www.novasupplyrd.com

RSS468 ROOFING SYSTEM

RSS468屋面系统

RSS468系统是在美式系统的基础上, 结合中国的实际情况的改进型, 对系统中的部分配套构件做了改进, 集各家的优点于一身, 更加完美。

On the basis of the US system, RSS468 Roofing System combines the actual conditions of China, improves part components of the system and integrates advantages of all systems to become better.

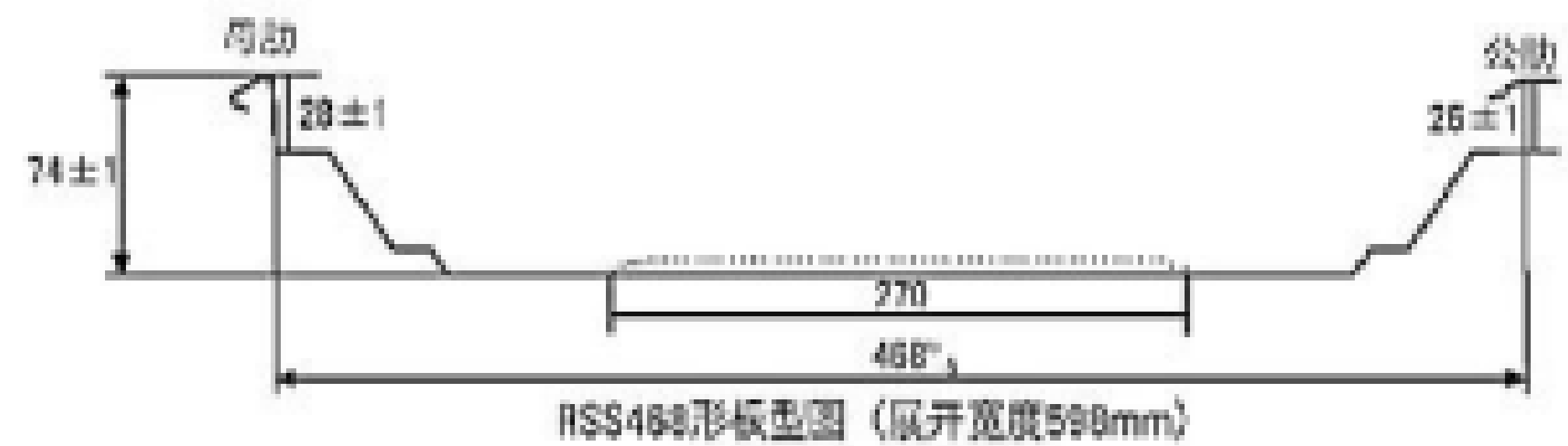

压型钢板型号TYPE	RSS468	用途
有效覆盖宽度 (mm) EFFECT WIDTH	468	APPLICATION
展开宽度 (mm) FEEDING WIDTH	600	
板厚 (mm) THICKNESS	0.5	0.6
截面惯性矩 (cm ⁴ /m) SECTION INERTIA	35.23	42.21
截面抵抗矩 (cm ³ /m) SECTION RESISTANC	21.65	25.86
		隐藏式屋面板
		DLS-Roof Panel

468压型板360°咬合示意图 468 CORRUGATED 360° MESHING DIAGRAM

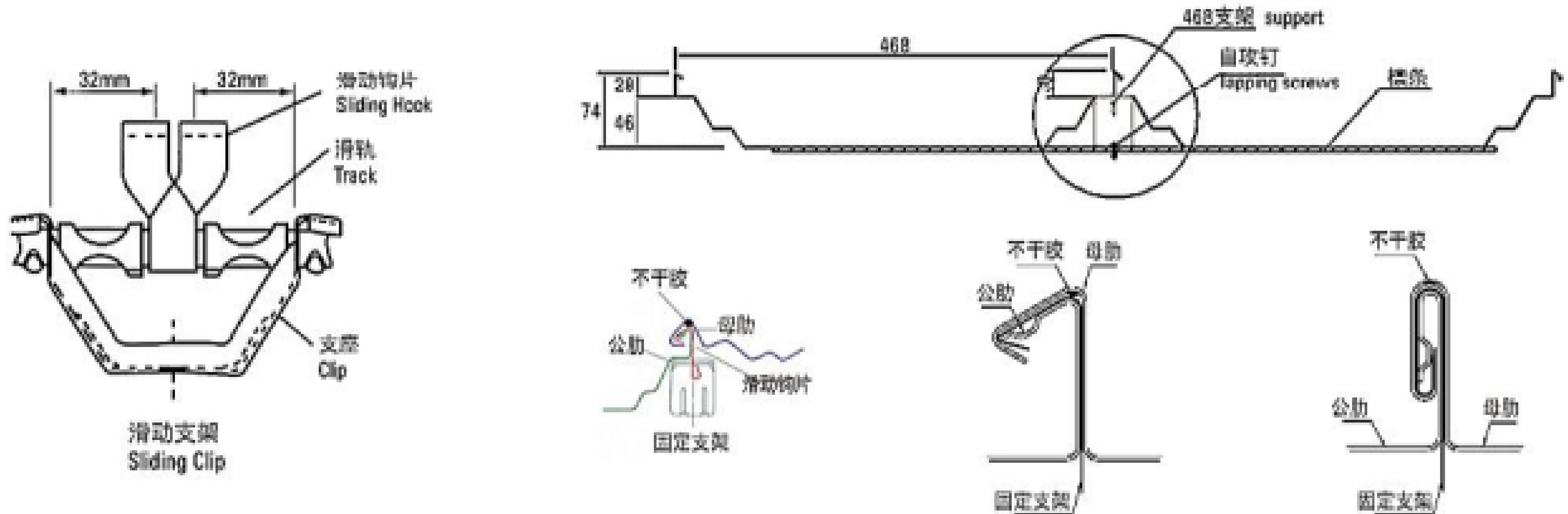

独特的隐藏式支架安装, 系统表面无螺钉穿透, 支架与板的连接为滑移型独特设计, 克服了超长板与固定支架由于热胀冷缩而产生的位移。

360度直立缝咬合公母肋, 肋高74 ± 1mm, 专业的涂胶设备可提供接缝预制不干胶, 使该系统在同类系统中具有极佳的防水性能。

可供选择多种金属材质压制, 并提供具有同等寿命的各种附件产品。

流程化的设备箱体式装运、专业的操作技能, 保证了大型项目精准的现场压制。

The unique hidden support installation, non-penetration of screws on system surface and the unique sliding design for the support and panel connection overcome the displacement of super long panels and fixed supports caused by the phenomena of expanding with heat and contracting with cold. Due to the 360 vertical seam-locking male and female ribs, the 74 ± 1mm-high ribs and the professional adhesive equipment which can provide prefabricated pressure-sensitive adhesive, the system has excellent waterproof performance among systems of the same kind. Wiskind can provide multiple metal materials for pressing production and various accessory products of the same service life. Standard equipment box shipment and professional operating skills have guaranteed the on-site precision pressing production of large projects.

(829) 216-9224

Plaza Roaldi, local 308, El Millon, D.N.

✉ info@novasupplyrd.com

🌐 www.novasupplyrd.com

万事达® 我们的客户
OUR CUSTOMERS

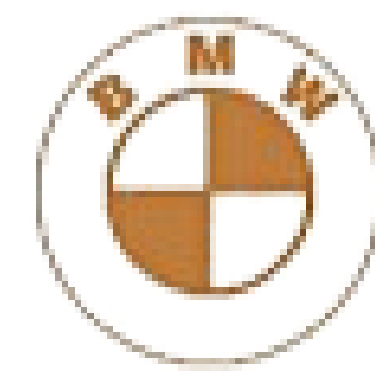
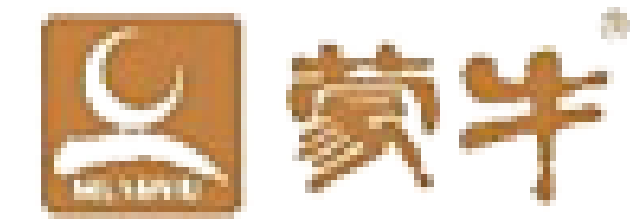
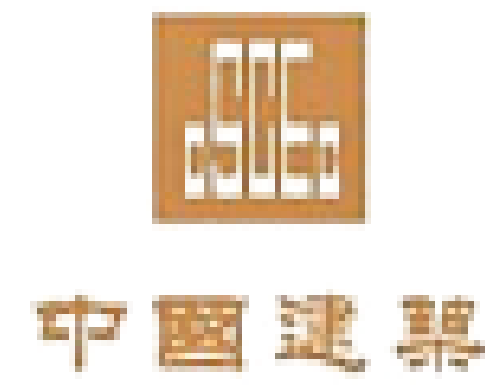

WISKIND PROJECT

万事达® 工程案例



公共建筑 Public Buildings

- 1 2010上海世博会德国馆
 - 2 山东美术馆
 - 3 沈阳北站
 - 4 重庆江北国际机场T3航站楼
 - 5 东平体育中心
-
- 1 German Pavillion of Shanghai World Expo in 2010
 - 2 Shandong Art Museum
 - 3 North Railway Station of Shenyang
 - 4 T3 Terminal of Chongqing Jiangbei International Airport
 - 5 Dongping Sports Center

(829) 216-9224

Plaza Roaldi, local 308, El Millon, D.N.

✉ info@novasupplyrd.com

🌐 www.novasupplyrd.com

WISKIND PROJECT

万事达® 工程案例

商业建筑 Commercial buildings

- 泰山封禅大典 1
- 融创·北京壹号院 2
- 天元购物广场 3
- 山西晋商银行中心大厦 4
- 威海帝景湾假日酒店 5

- Worship Ceremony at Mount. Tai 1
- Sunac · Beijing Courtyard No. 1 2
- Tianyuan Shopping Mall 3
- Shanxi Jinshang Bank Center Building 4
- Weihai Dijingwang Holiday Hotel 5



(829) 216-9224

Plaza Roaldi, local 308, El Millon, D.N.

✉ info@novasupplyrd.com

🌐 www.novasupplyrd.com



电力能源
Electrical energy

- 1 北京东北热电高安屯电厂
- 2 鲁能内蒙古鄂温克电厂
- 3 秦山核电站
- 4 北京西北热电中心京能燃气热电厂

- 1 Gaoantun Power Plant of Beijing Dongbei Thermal Power Plant
- 2 Luneng Inner Mongolia Ewenki Power Plant
- 3 Qinshan Nuclear Power Plant
- 4 Jingneng Gas Thermal Power Plant of Beijing Xibei Thermal Power Center



(829) 216-9224

Plaza Roaldi, local 308, El Millon, D.N.

✉ info@novasupplyrd.com

🌐 www.novasupplyrd.com

WISKIND PROJECT

万事达® 工程案例

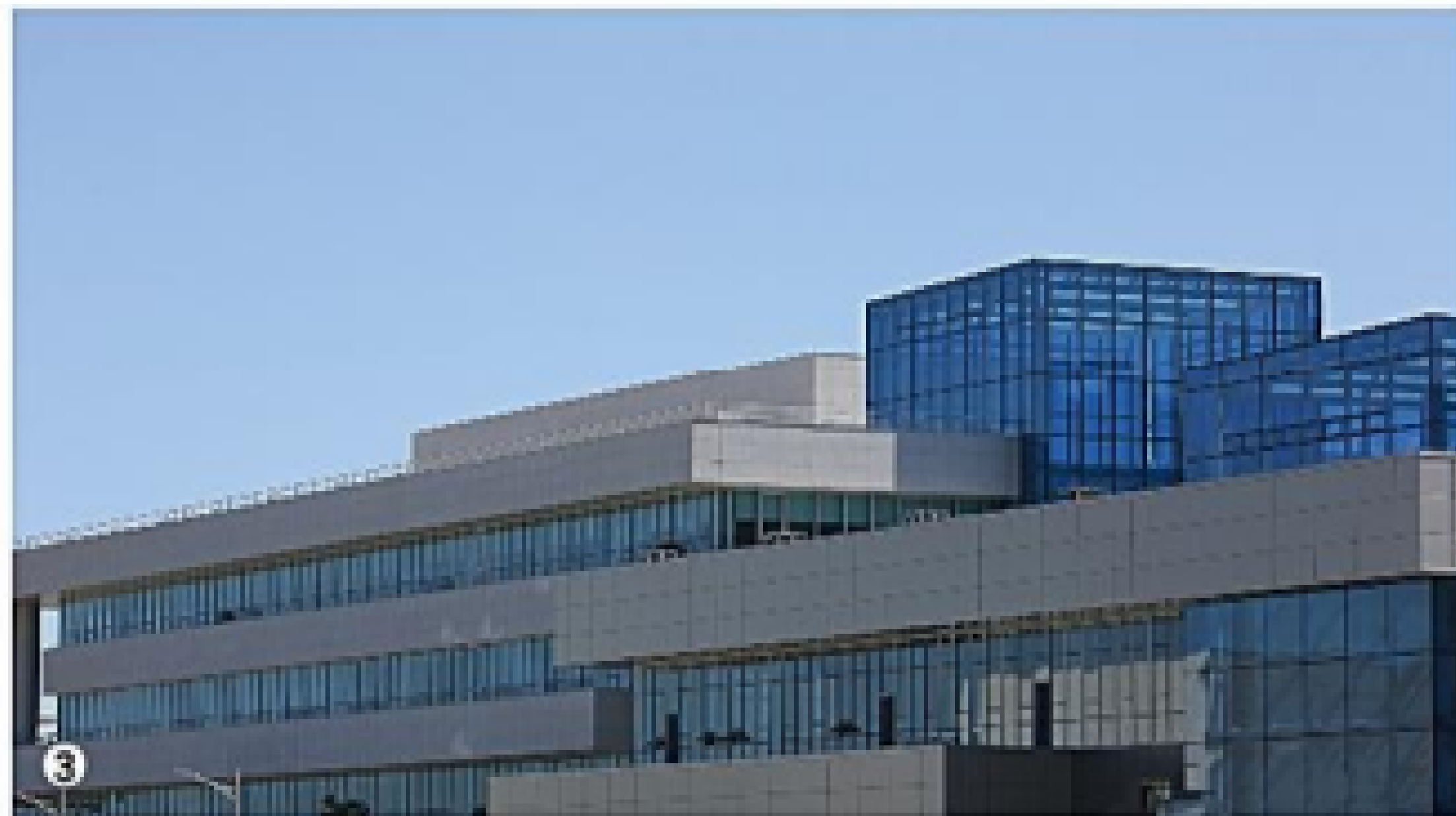

车辆制造 Vehicle manufacturing

- 1 徐工集团
- 2 江淮汽车
- 3 现代汽车(中国)研发中心
- 4 中车集团大连机车
- 5 北京现代摩比斯变速器有限公司

- 1 JAC Motors
- 2 XCMG
- 3 Hyundai Motor (China) Research and Development Center
- 4 CNR Dalian Locomotive & Rolling Stock Co., Ltd.
- 5 Beijing Hyundai Mobis Speed Transmissions Co., Ltd.

(829) 216-9224

Plaza Roaldi, local 308, El Millon, D.N.

✉ info@novasupplyrd.com

🌐 www.novasupplyrd.com



工业制造
Industrial manufacturing

- 豪迈机械 1
- 南山集团航空产业园 2
- 潍柴动力 3
- 中海油工程(青岛)有限公司 4
- 贝英数控 5

- Himile Mechanical 1
- Nanshan Group Aviation Industrial Park 2
- Weichai Power Co., Ltd. 3
- CNOOC Engineering (Qingdao) Co., Ltd. 4
- Puyang BEAIN CNC Machinery and Equipment Co., Ltd. 5

(829) 216-9224

Plaza Roaldi, local 308, El Millon, D.N.

✉ info@novasupplyrd.com

🌐 www.novasupplyrd.com

WISKIND PROJECT

万事达® 工程案例

食品医疗 Food and Medical

- 可口可乐 1
- 新华制药股份有限公司 2
- 天津白肯食品冷链物流项目 3
- 山东大学齐鲁医院 4
- 山东美奥生物 5

- Coca-Cola(China) Beverages CO.,LTD 1
- Shandong Xinhua Pharmaceutical CO.,LTD 2
- Tianjin White Ken Food Cold Chain Logistics Project 3
- Qilu Hospital of Shandong University 4
- Shandong Mei'ao Bioengineering Co., Ltd. 5



(829) 216-9224

Plaza Roaldi, local 308, El Millon, D.N.

✉ info@novasupplyrd.com

🌐 www.novasupplyrd.com



其他
Else

- 1 尤妮佳生活用品(天津)有限公司
- 2 德国汉高龙项目
- 3 歌尔电子
- 4 山西美特好农产品加工配送中心
- 5 信泰电子
- 6 清华核能研究院

- 1 Unicharm Daily Use Articles (Tianjin) Co., Ltd.
- 2 Germany Henkel Dragon Project
- 3 Goertek Electronics
- 4 Shanxi Meet All Agricultural Product Processing and Distribution Center
- 5 Xintai Electronic Technology
- 6 The Institute of Nuclear and New Energy Technology of Tsinghua University



(829) 216-9224

Plaza Roaldi, local 308, El Millon, D.N.

✉ info@novasupplyrd.com

🌐 www.novasupplyrd.com